

REVISION	DATE	BY	CHKD
ADDED DBA TO 280, 286, 480, V08, REMOVED DBA FROM K1, K15.	04/08/2013	017	DDJ
NO CHANGE	10/01/2013	018	DDJ
ADDED DBA TO 522, MOVED DBA FROM 120 TO 305, REMOVED DBA FROM 295.	04/07/2014	019	DDJ
COMBINED 240-270 FOR NEW ANCHOR, COMBINED 285-295 FOR RELO DBA, COMBO 295-295B FOR RELO, REVISED DBA FOR 422, 310, 145.	10/01/2014	020	DDJ
REMOVED DBA FROM 508, 480, 400, 280, K12, FC5, FC6, 170, 155.	04/06/2015	021	DDJ
COMBINED 500, 505 & 508 FOR NEW DBA, ADDED DBA TR0 425, K10, 400, 280, FC5, FC6, 120, EXPANDED 455, REVISED DBA FOR 445, 360, 518, REMOVED DBA FROM 370, 335, V09, REMOVED K12.	10/01/2015	022	DDJ
ADDED DBA TO K7, 400, EXPANDED 338 INTO 335, REMOVED DBA FROM FC5, K10, 375, 370, 340.	04/09/2016	023	DDJ
ADDED DBA TO 460.	10/01/2016	024	DDJ
ADDED DBA TO 460.	10/01/2016	025	DDJ
EXPANDED 175, REVISED DBA FOR 345, MOVED DBA FROM 130 TO 370, REMOVED DBA FROM 170, RECONF 170 PER ARCH LOD.	04/10/2017	026	DDJ
ADDED DBA TO FC-5, 286, RELOCATED DBA FROM 280 TO 130.	10/01/2017	027	DDJ

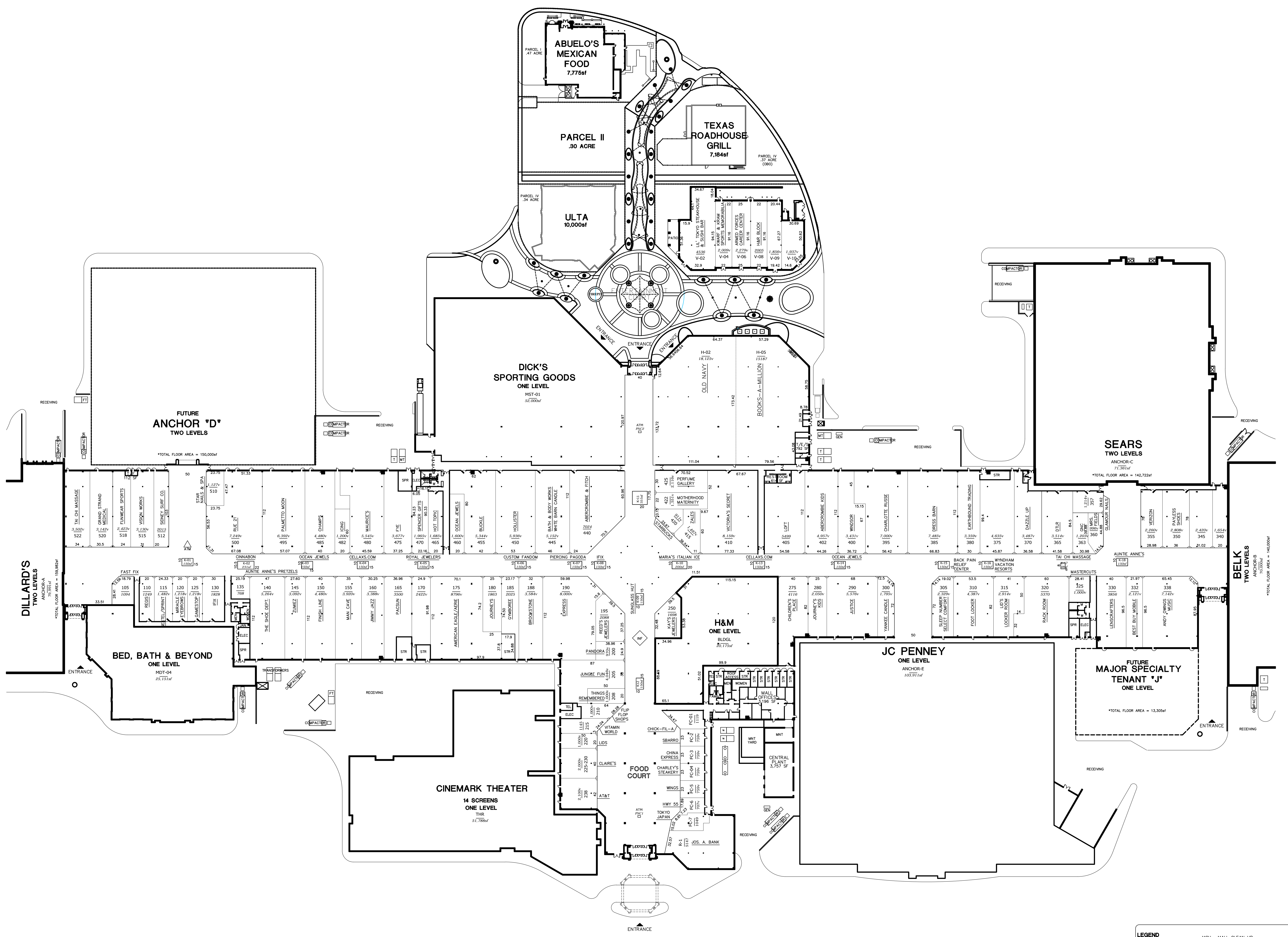

CBL
CBL & ASSOCIATES PROPERTIES, INC.
 CBL Center, Suite 500, 2030 Hamilton Place Boulevard, Chattanooga, TN 37421-6000
 P: 423.885.0001 | F: 423.885.8666 | info@cblproperties.com | NYSE: CBL

LEASE PLAN

COASTAL GRAND
 2030 COASTAL GRAND CIRCLE, WHITE BEACH, SC
 Phone: (843)839-9110

LEGEND	MCU - MALL CLEAN UP
INF - INFORMATION BOOTH	MNT - MAINTENANCE RM
DIR - MALL DIRECTORY	ELEV - ELEVATOR
STR - MALL STORAGE	EER - ELEV EQUIP RM
TEL - TELEPHONE	SPR - SPRINKLER RM
LOC - LOCKERS	ELEC - ELECTRICAL RM
CAN - CAN WASH	SGR - SWITCH GEAR RM
JCL - JANITOR CLOSET	TRAN - TRANSFORMER

SCALE: 1"=50'

REVISION: DDJ

DATE: 04/01/2005

CAD FILENAME: CGLP1

DRAWING NUMBER: LP 1

EXHIBIT PRINTING DATE: 10/01/2017

0 20' 40' 80' 120'

NORTH

COASTAL GRAND

THIS PLAN SHALL NOT BE DEEMED TO BE A WARRANTY, REPRESENTATION OR AGREEMENT ON THE PART OF THE LANDLORD THAT THE SHOPPING CENTER WILL BE, OR WILL CONTINUE TO BE AS INDICATED HEREON WITHOUT CHANGE. LANDLORD MAY, FROM TIME TO TIME, INCREASE, REDUCE, AND/OR CHANGE THE PARKING AREAS OR COMMON AREAS AS LANDLORD SHALL DEEM PROPER. LANDLORD RESERVES THE RIGHT TO CHANGE THE GENERAL LAYOUT, AND TO MAKE ALTERATIONS AND ADDITIONS TO, AND TO BUILD ADDITIONAL STORIES ON THE BUILDING IN WHICH THE PREMISES ARE CONTAINED OR WHICH OTHERWISE COMPRISE THE SHOPPING CENTER AND TO MAKE ANY OTHER CHANGES AS MAY BE REQUIRED BY APPLICABLE CODE OR AUTHORITIES. THIS PLAN IS SUBJECT TO CHANGE, AND IS NOT A WARRANTY, REPRESENTATION OR AGREEMENT THAT PROSPECTIVE TENANTS OR ANCHOR STORES SHOWN HEREON WILL BE TENANTS OR ANCHOR STORES AT THE LOCATIONS SHOWN OR AT ANY OTHER LOCATION IN THE SHOPPING CENTER.