

BELK
TWO LEVELS

*TOTAL FLOOR AREA = 188,150sf

A

94,075sf

DILLARD'S
TWO LEVELS

*TOTAL FLOOR AREA = 181,028sf

B

90,514sf

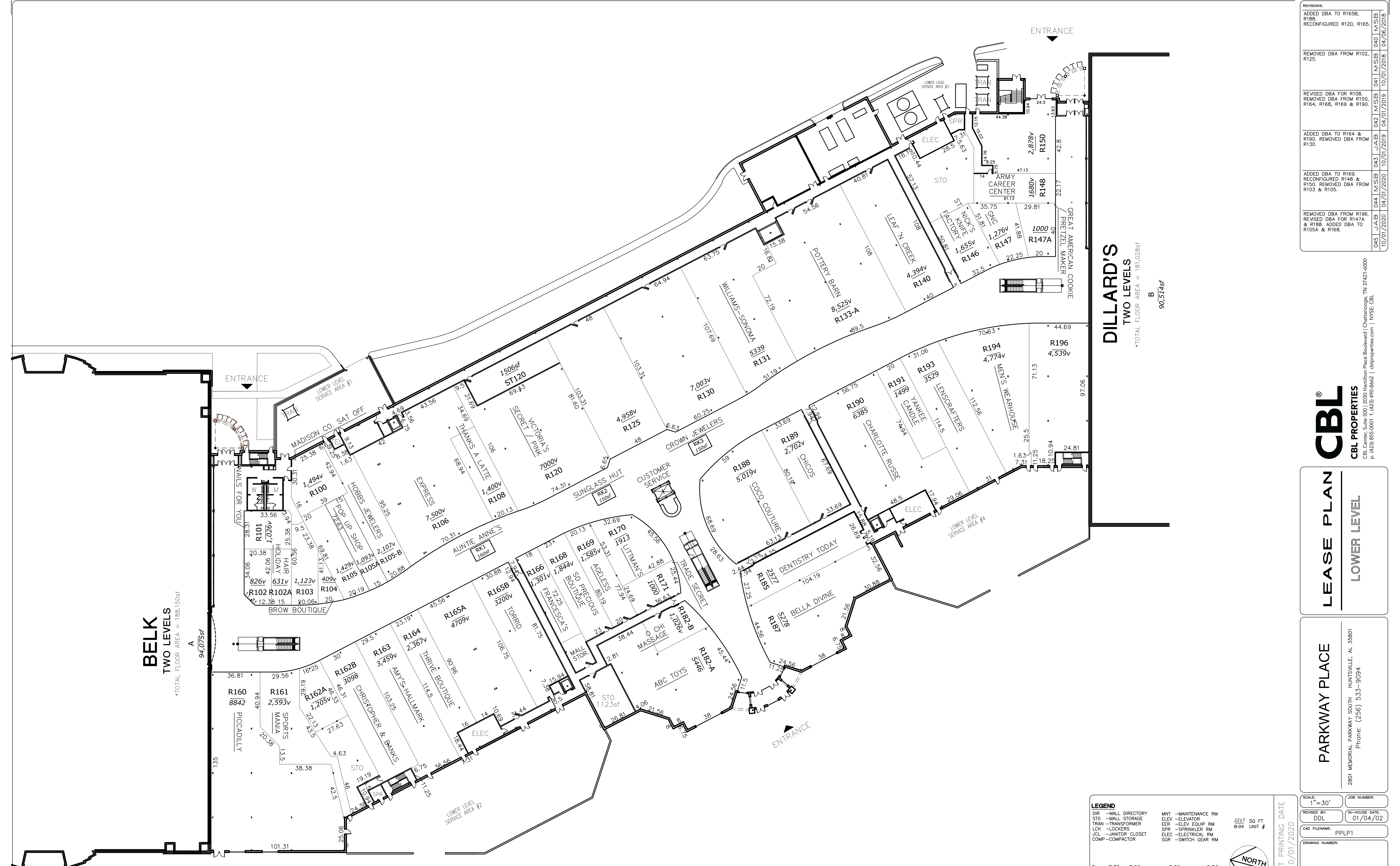

NO.	DATE	BY	DESCRIPTION
045	JAN	JAB	REMOVED DBA FROM R196, R188, R187, R186, R185, R184, R183, R182, R181, R180, R179, R178, R177, R176, R175, R174, R173, R172, R171, R170, R169, R168, R167, R166, R165, R164, R163, R162, R161, R160, R159, R158, R157, R156, R155, R154, R153, R152, R151, R150, R149, R148, R147, R146, R145, R144, R143, R142, R141, R140, R139, R138, R137, R136, R135, R134, R133, R132, R131, R130, R129, R128, R127, R126, R125, R124, R123, R122, R121, R120, R119, R118, R117, R116, R115, R114, R113, R112, R111, R110, R109, R108, R107, R106, R105, R104, R103, R102, R101, R100, R99, R98, R97, R96, R95, R94, R93, R92, R91, R90, R89, R88, R87, R86, R85, R84, R83, R82, R81, R80, R79, R78, R77, R76, R75, R74, R73, R72, R71, R70, R69, R68, R67, R66, R65, R64, R63, R62, R61, R60, R59, R58, R57, R56, R55, R54, R53, R52, R51, R50, R49, R48, R47, R46, R45, R44, R43, R42, R41, R40, R39, R38, R37, R36, R35, R34, R33, R32, R31, R30, R29, R28, R27, R26, R25, R24, R23, R22, R21, R20, R19, R18, R17, R16, R15, R14, R13, R12, R11, R10, R9, R8, R7, R6, R5, R4, R3, R2, R1
044	JAN	JAB	REMOVED DBA FROM R196, R188, R187, R186, R185, R184, R183, R182, R181, R180, R179, R178, R177, R176, R175, R174, R173, R172, R171, R170, R169, R168, R167, R166, R165, R164, R163, R162, R161, R160, R159, R158, R157, R156, R155, R154, R153, R152, R151, R150, R149, R148, R147, R146, R145, R144, R143, R142, R141, R140, R139, R138, R137, R136, R135, R134, R133, R132, R131, R130, R129, R128, R127, R126, R125, R124, R123, R122, R121, R120, R119, R118, R117, R116, R115, R114, R113, R112, R111, R110, R109, R108, R107, R106, R105, R104, R103, R102, R101, R100, R99, R98, R97, R96, R95, R94, R93, R92, R91, R90, R89, R88, R87, R86, R85, R84, R83, R82, R81, R80, R79, R78, R77, R76, R75, R74, R73, R72, R71, R70, R69, R68, R67, R66, R65, R64, R63, R62, R61, R60, R59, R58, R57, R56, R55, R54, R53, R52, R51, R50, R49, R48, R47, R46, R45, R44, R43, R42, R41, R40, R39, R38, R37, R36, R35, R34, R33, R32, R31, R30, R29, R28, R27, R26, R25, R24, R23, R22, R21, R20, R19, R18, R17, R16, R15, R14, R13, R12, R11, R10, R9, R8, R7, R6, R5, R4, R3, R2, R1
043	JAN	JAB	ADDED DBA TO R164 & R190. REMOVED DBA FROM R130.
042	JAN	JAB	REMOVED DBA FROM R102, R125.
041	MAR	MAB	REMOVED DBA FROM R102, R125.
040	MAR	MAB	REMOVED DBA FROM R102, R125.
039	MAR	MAB	REMOVED DBA FROM R102, R125.
038	MAR	MAB	REMOVED DBA FROM R102, R125.
037	MAR	MAB	REMOVED DBA FROM R102, R125.
036	MAR	MAB	REMOVED DBA FROM R102, R125.
035	MAR	MAB	REMOVED DBA FROM R102, R125.
034	MAR	MAB	REMOVED DBA FROM R102, R125.
033	MAR	MAB	REMOVED DBA FROM R102, R125.
032	MAR	MAB	REMOVED DBA FROM R102, R125.
031	MAR	MAB	REMOVED DBA FROM R102, R125.
030	MAR	MAB	REMOVED DBA FROM R102, R125.
029	MAR	MAB	REMOVED DBA FROM R102, R125.
028	MAR	MAB	REMOVED DBA FROM R102, R125.
027	MAR	MAB	REMOVED DBA FROM R102, R125.
026	MAR	MAB	REMOVED DBA FROM R102, R125.
025	MAR	MAB	REMOVED DBA FROM R102, R125.
024	MAR	MAB	REMOVED DBA FROM R102, R125.
023	MAR	MAB	REMOVED DBA FROM R102, R125.
022	MAR	MAB	REMOVED DBA FROM R102, R125.
021	MAR	MAB	REMOVED DBA FROM R102, R125.
020	MAR	MAB	REMOVED DBA FROM R102, R125.
019	MAR	MAB	REMOVED DBA FROM R102, R125.
018	MAR	MAB	REMOVED DBA FROM R102, R125.
017	MAR	MAB	REMOVED DBA FROM R102, R125.
016	MAR	MAB	REMOVED DBA FROM R102, R125.
015	MAR	MAB	REMOVED DBA FROM R102, R125.
014	MAR	MAB	REMOVED DBA FROM R102, R125.
013	MAR	MAB	REMOVED DBA FROM R102, R125.
012	MAR	MAB	REMOVED DBA FROM R102, R125.
011	MAR	MAB	REMOVED DBA FROM R102, R125.
010	MAR	MAB	REMOVED DBA FROM R102, R125.
009	MAR	MAB	REMOVED DBA FROM R102, R125.
008	MAR	MAB	REMOVED DBA FROM R102, R125.
007	MAR	MAB	REMOVED DBA FROM R102, R125.
006	MAR	MAB	REMOVED DBA FROM R102, R125.
005	MAR	MAB	REMOVED DBA FROM R102, R125.
004	MAR	MAB	REMOVED DBA FROM R102, R125.
003	MAR	MAB	REMOVED DBA FROM R102, R125.
002	MAR	MAB	REMOVED DBA FROM R102, R125.
001	MAR	MAB	REMOVED DBA FROM R102, R125.

CBL PROPERTIES
CBL Center, Suite 500 | 2030 Hamilton Place Boulevard | Chattanooga, TN 37421-6000
P: (423) 855-0001 | F: (423) 490-8662 | cblproperties.com | NYSE: CBL

LEASE PLAN
LOWER LEVEL

PARKWAY PLACE
2801 MEMORIAL PARKWAY SOUTH | HUNTSVILLE, AL 35801
Phone: (256) 533-9094

LEGEND
DIR - MALL DIRECTORY
STO - MALL STORAGE
TRAN - TRANSFORMER
LCK - LOCKERS
JCL - JANITOR CLOSET
COMP - COMPACTOR
MNT - MAINTENANCE RM
ELEV - ELEVATOR
EER - ELEV EQUIP RM
SPR - SPRINKLER RM
ELEC - ELECTRICAL RM
SGR - SWITCH GEAR RM

2217 SQ FT
B-04 UNIT #

SCALE: 1" = 30'

REVISIONS: DDL 01/04/02

CAD FILENAME: PPLP1

DRAWING NUMBER: LP 1

EXHIBIT PRINTING DATE: 10/01/2020

JOB NUMBER: 01/04/02

IN-HOUSE DATE: 01/04/02

THIS PLAN SHALL NOT BE DEEMED TO BE A WARRANTY, REPRESENTATION OR AGREEMENT ON THE PART OF THE LANDLORD THAT THE SHOPPING CENTER WILL BE, OR WILL CONTINUE TO BE AS INDICATED HEREON WITHOUT CHANGE. LANDLORD MAY, FROM TIME TO TIME, INCREASE, REDUCE, AND/OR CHANGE THE PARKING AREAS OR COMMON AREAS AS LANDLORD SHALL DEEM PROPER. LANDLORD RESERVES THE RIGHT TO CHANGE THE GENERAL LAYOUT, AND TO MAKE ALTERATIONS AND ADDITIONS TO, AND TO BUILD ADDITIONAL STORIES ON THE BUILDING IN WHICH THE PREMISES ARE CONTAINED OR WHICH OTHERWISE COMPRISE THE SHOPPING CENTER AND TO MAKE ANY OTHER CHANGES AS MAY BE REQUIRED BY APPLICABLE CODE OR AUTHORITIES. THIS PLAN IS SUBJECT TO CHANGE, AND IS NOT A WARRANTY, REPRESENTATION OR AGREEMENT THAT PROSPECTIVE TENANTS OR ANCHOR STORES SHOWN HEREON WILL BE TENANTS OR ANCHOR STORES AT THE LOCATIONS SHOWN OR AT ANY OTHER LOCATION IN THE SHOPPING CENTER.