

F.A.I. ROUTE I-64

REVISIONS:

04/09/2012	REVISED STATUS
10/01/2012	REVISED STATUS
04/08/2013	REVISED STATUS
10/01/2013	REVISED STATUS
04/07/2014	REVISED STATUS
10/01/2014	REVISED STATUS
04/06/2015	REVISED STATUS
10/01/2015	REVISED STATUS
04/06/2016	REVISED STATUS
10/01/2016	REVISED STATUS
04/10/2017	REVISED STATUS
10/01/2017	REVISED STATUS
04/06/2018	REVISED STATUS
10/01/2018	REVISED STATUS
02/04/2019	OVERLAPED 2019 SURVEY CBL FILE REVISED PARKING STATUS
04/01/2019	REMOVED DBA FROM BUILDING A REVISED STATUS
10/01/2019	ADDED DBA TO OP-06 REVISED STATUS
04/01/2020	REMOVED DBA FOR 1-B REMOVED DBA FROM 2-B
10/01/2020	REMOVED DBA FROM 1E & 2-F

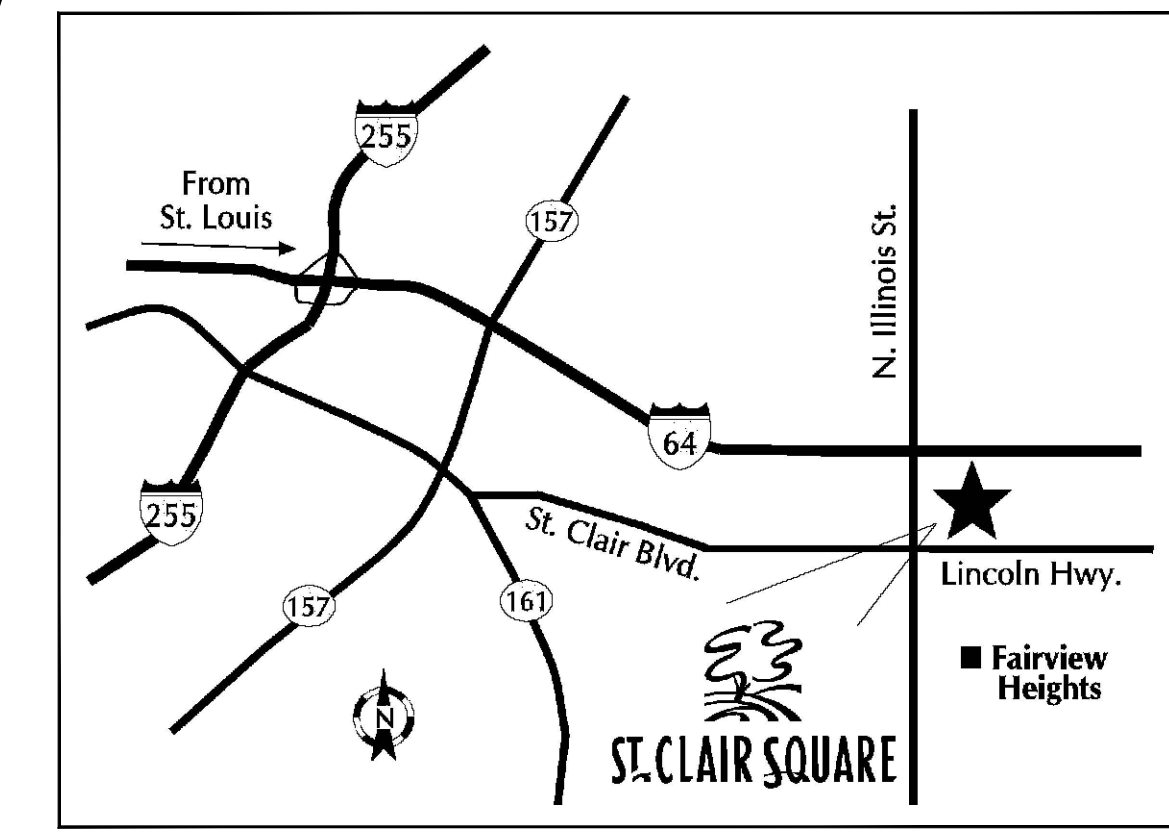
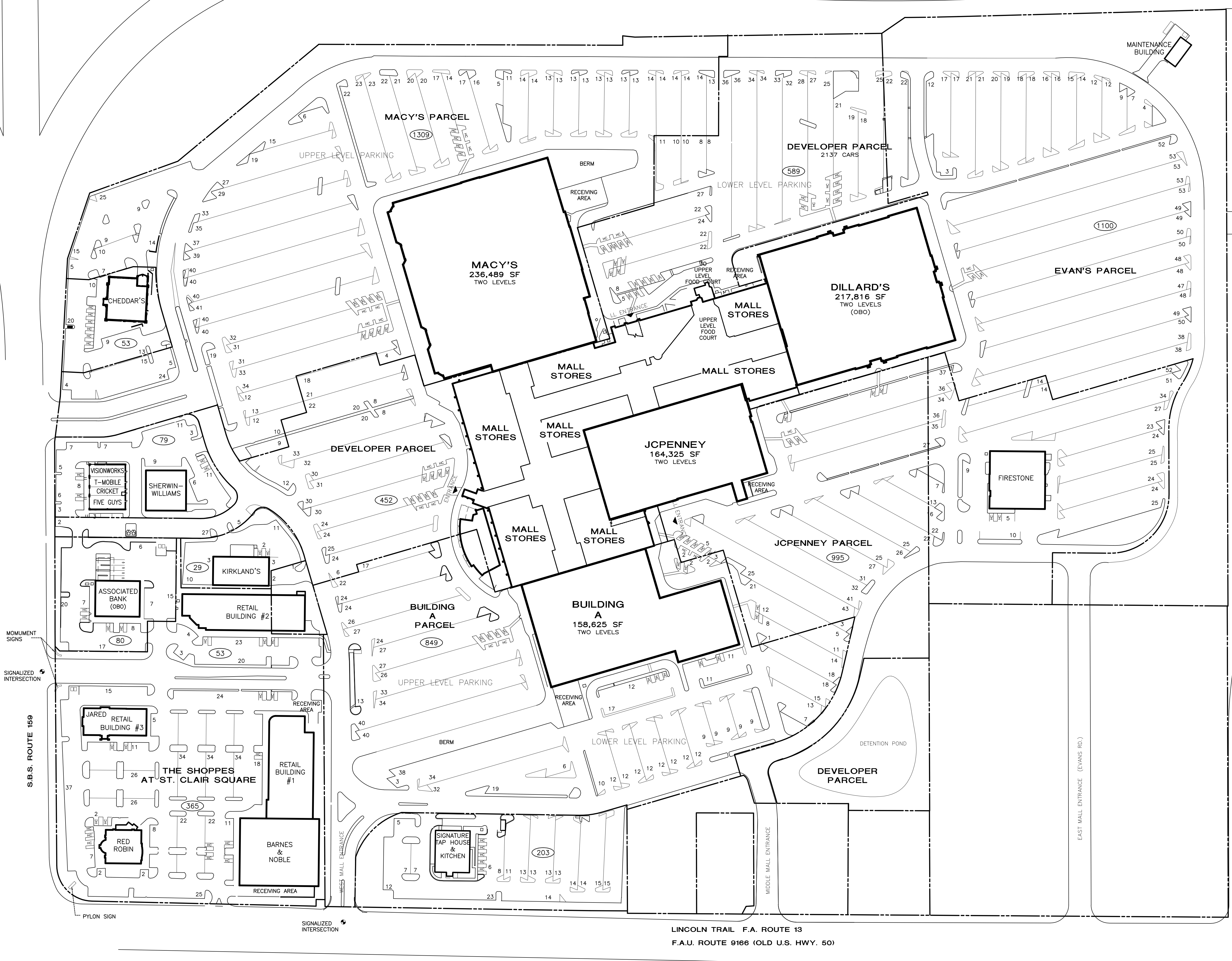

SITE LOCATION MAP

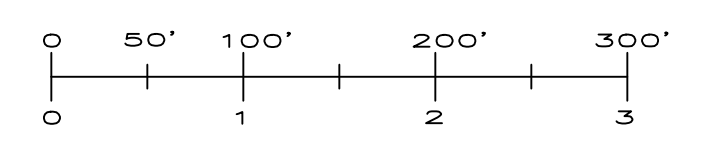

LEGEND

	ENTRANCE LOCATION
	HANDICAP PARKING

LINCOLN TRAIL F.A. ROUTE 13
F.A.U. ROUTE 9166 (OLD U.S. HWY. 50)

ST CLAIR SQUARE

CBL
CBL PROPERTIES
CBL Center, Suite 500 | 2030 Hamilton Place Boulevard | Chattanooga, TN 37421-0000
P: (423) 855-0001 | F: (423) 496-8662 | cblproperties.com | NYSE: CBL

SITE PLAN

ST. CLAIR SQUARE
FAIRVIEW HEIGHTS, IL 62208
PHONE: 618-632-7567

SCALE: 1"=100'	JOB NUMBER:
REVISED BY: AYS	IN-HOUSE DATE: 11/28/20
CAD FILENAME: SCSITE	
DRAWING NUMBER:	

SP 1

THIS PLAN SHALL NOT BE DEEMED TO BE A WARRANTY, REPRESENTATION OR AGREEMENT ON THE PART OF THE LANDLORD THAT THE SHOPPING CENTER WILL BE, OR WILL CONTINUE TO BE AS INDICATED HEREON WITHOUT CHANGE. LANDLORD MAY, FROM TIME TO TIME, INCREASE, REDUCE, AND/OR CHANGE THE PARKING AREAS OR COMMON AREAS AS LANDLORD SHALL DEEM PROPER. LANDLORD RESERVES THE RIGHT TO CHANGE THE GENERAL LAYOUT, AND TO MAKE ALTERATIONS AND ADDITIONS TO, AND TO BUILD ADDITIONAL STORIES ON THE BUILDING IN WHICH THE PREMISES ARE CONTAINED OR WHICH OTHERWISE COMPRISE THE SHOPPING CENTER AND TO MAKE ANY OTHER CHANGES AS MAY BE REQUIRED BY APPLICABLE CODE OR AUTHORITIES. THIS PLAN IS SUBJECT TO CHANGE, AND IS NOT A WARRANTY, REPRESENTATION OR AGREEMENT THAT PROSPECTIVE TENANTS OR ANCHOR STORES SHOWN HEREON WILL BE TENANTS OR ANCHOR STORES AT THE LOCATIONS SHOWN OR AT ANY OTHER LOCATION IN THE SHOPPING CENTER.