

NO.	DATE	DESCRIPTION
033	10/01/2020	ADDED DBA TO 2024, MOVED DBA FROM 2022 TO 1003, REMOVED DBA FROM 2052.
031	10/01/2019	ADDED DBA TO 2052, 2064, REVISED DBA FOR FC-06, FC-09, REMOVED DBA FROM 2093.
030	04/01/2019	REMOVED DBA FROM 2020 & GS-03.
029	04/01/2019	REVISED DBA FOR 2054, FC-06 & FC-09, ADDED DBA TO 2020 & GS-03.
028	04/01/2019	ADDED DBA TO FC-10, REMOVED DBA FROM FC-09 & K-2105.
027	10/01/2020	REMOVED DBA FROM 2024, 2038 & FC-02, REVISED DBA FOR 2020.

CBL PROPERTIES
 CBL Center, Suite 500 | 2030 Hamilton Place Boulevard | Chattanooga, TN 37421-6000
 P: (423) 855-0001 | F: (423) 490-8662 | cblproperties.com | NYSE: CBL

LEASE PLAN
UPPER LEVEL

LAYTON HILLS MALL
 1076 LAYTON HILLS MALL LAYTON, UTAH 84041
 Phone: (801) 546-3471

SCALE: 1" = 30'	JOB NUMBER:
REVISED BY: DDL	IN-HOUSE DATE: 11/07/2005
CAD FILENAME: LHLP1	DRAWING NUMBER: LP 2

LEGEND

DIR - MALL DIRECTORY	MNT - MAINTENANCE RM
STO - MALL STORAGE	ELEV - ELEVATOR
TRAN - TRANSFORMER	EER - ELEV EQUIP RM
LCK - LOCKERS	SPR - SPRINKLER RM
JCL - JANITOR CLOSET	ELEC - ELECTRICAL RM
COMP - COMPACTOR	SGR - SWITCH GEAR RM

2217 SQ FT
 B-04 UNIT #

0 15' 30' 60' 90'
 1 2 3

NORTH

EXHIBIT PRINTING DATE
 10/01/2020

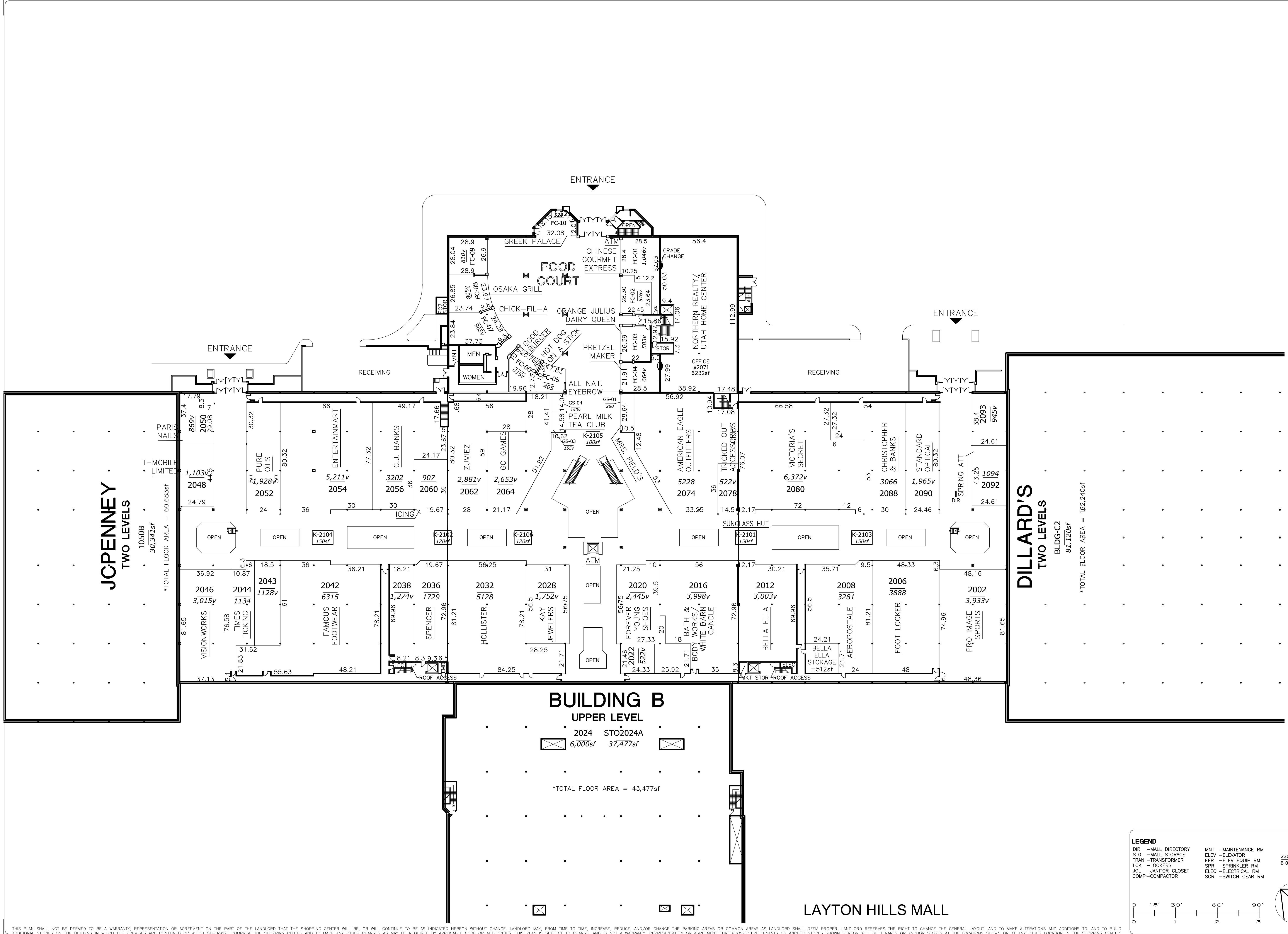

THIS PLAN SHALL NOT BE DEEMED TO BE A WARRANTY, REPRESENTATION OR AGREEMENT ON THE PART OF THE LANDLORD THAT THE SHOPPING CENTER WILL BE, OR WILL CONTINUE TO BE AS INDICATED HEREON WITHOUT CHANGE. LANDLORD MAY, FROM TIME TO TIME, INCREASE, REDUCE, AND/OR CHANGE THE PARKING AREAS OR COMMON AREAS AS LANDLORD SHALL DEEM PROPER. LANDLORD RESERVES THE RIGHT TO CHANGE THE GENERAL LAYOUT, AND TO MAKE ALTERATIONS AND ADDITIONS TO, AND TO BUILD ADDITIONAL STORIES ON THE BUILDING IN WHICH THE PREMISES ARE CONTAINED OR WHICH OTHERWISE COMPRISE THE SHOPPING CENTER AND TO MAKE ANY OTHER CHANGES AS MAY BE REQUIRED BY APPLICABLE CODE OR AUTHORITIES. THIS PLAN IS SUBJECT TO CHANGE, AND IS NOT A WARRANTY, REPRESENTATION OR AGREEMENT THAT PROSPECTIVE TENANTS OR ANCHOR STORES SHOWN HEREON WILL BE TENANTS OR ANCHOR STORES AT THE LOCATIONS SHOWN OR AT ANY OTHER LOCATION IN THE SHOPPING CENTER.