

DILLARD'S WEST
WOMEN & HOME
TWO LEVELS

6700B
96,625sf

*TOTAL FLOOR AREA = 193,250sf

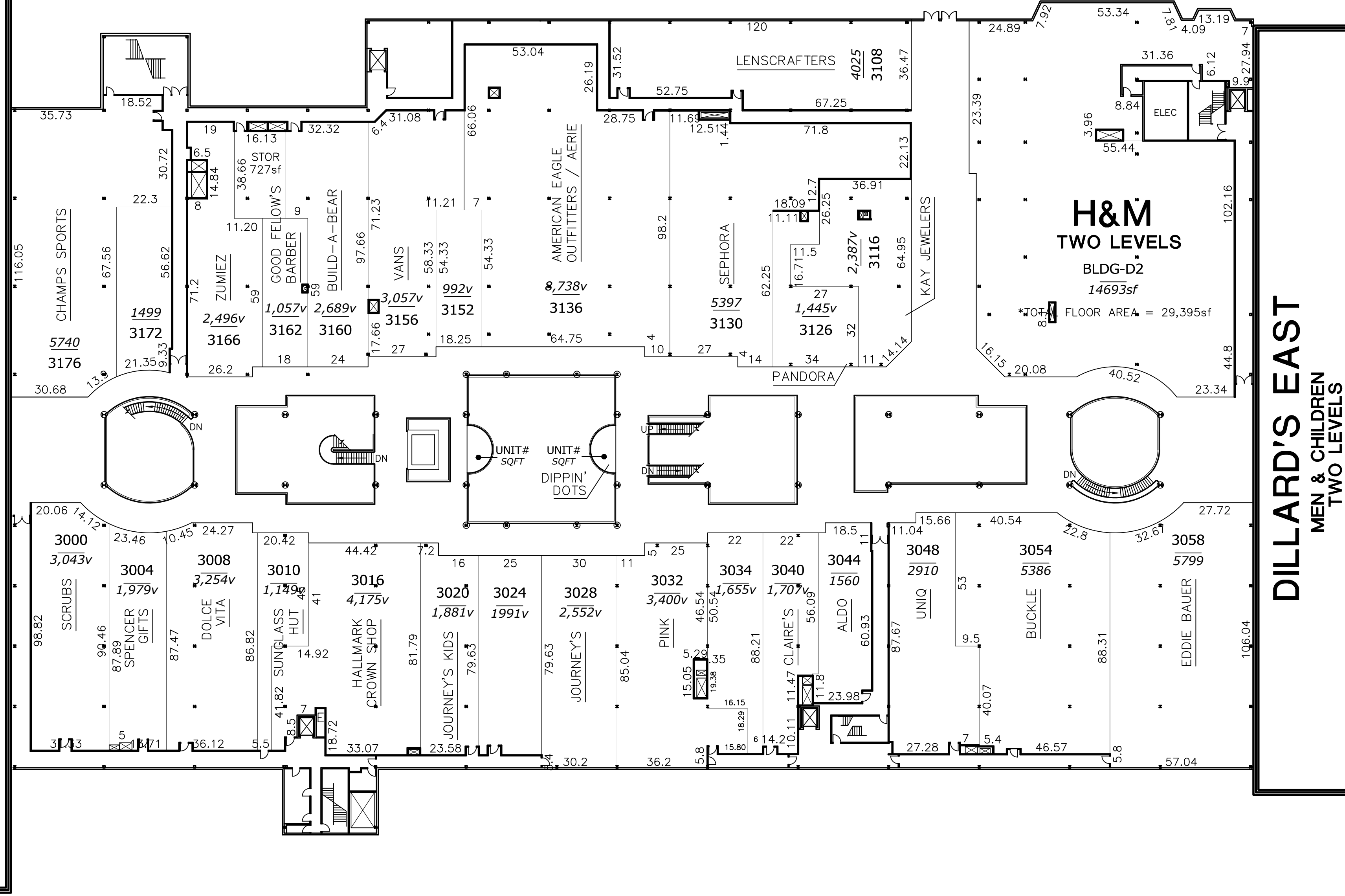

DILLARD'S EAST
MEN & CHILDREN
TWO LEVELS

6701B
42,787sf

*TOTAL FLOOR AREA = 85,574sf

PARK PLAZA MALL

THIS PLAN SHALL NOT BE DEEMED TO BE A WARRANTY, REPRESENTATION OR AGREEMENT ON THE PART OF THE LANDLORD THAT THE SHOPPING CENTER WILL BE, OR WILL CONTINUE TO BE AS INDICATED HEREON WITHOUT CHANGE. LANDLORD MAY, FROM TIME TO TIME, INCREASE, REDUCE, AND/OR CHANGE THE PARKING AREAS OR COMMON AREAS AS LANDLORD SHALL DEEM PROPER. LANDLORD RESERVES THE RIGHT TO CHANGE THE GENERAL LAYOUT, AND TO MAKE ALTERATIONS AND ADDITIONS TO, AND TO BUILD ADDITIONAL STORIES ON THE BUILDING IN WHICH THE PREMISES ARE CONTAINED OR WHICH OTHERWISE COMPRISE THE SHOPPING CENTER AND TO MAKE ANY OTHER CHANGES AS MAY BE REQUIRED BY APPLICABLE CODE OR AUTHORITIES. THIS PLAN IS SUBJECT TO CHANGE, AND IS NOT A WARRANTY, REPRESENTATION OR AGREEMENT THAT PROSPECTIVE TENANTS OR ANCHOR STORES SHOWN HEREON WILL BE TENANTS OR ANCHOR STORES AT THE LOCATIONS SHOWN OR AT ANY OTHER LOCATION IN THE SHOPPING CENTER.

LEGEND

DIR - MALL DIRECTORY	MNT - MAINTENANCE RM
STO - MALL STORAGE	ELEV - ELEVATOR
TRN - TRANSFORMER	EER - ELEV EQUIP RM
TKC - LOCKERS	SPR - SPRINKLER RM
WCK - WORKERS CLOSET	ELEC - ELECTRICAL RM
COM - COMPACTOR	SGR - SWITCH GEAR RM

SCALE: 1" = 30'

REVISIONS: NO CHANGES.

EXHIBIT PRINTING DATE: 04/01/2019

2217 SQ FT
B-04 UNIT #

JOB NUMBER: PALP3

IN-HOUSE DATE: 06/22/2004

DRAWING NUMBER: LP 3

032	M/SB	031	M/SB	10/01/2018	10/01/2018	10/01/2018	10/01/2018
031	M/SB	030	M/SB	04/08/2018	04/08/2018	04/08/2018	04/08/2018
029	DDL	028	M/SB	04/10/2017	04/10/2017	04/10/2017	04/10/2017
027	LAYS	026	M/SB	04/10/2017	04/10/2017	04/10/2017	04/10/2017

CBL
CBL PROPERTIES
CBL Center, Suite 500 | 2030 Hamilton Place Boulevard | Chattanooga, TN 37421-6000
P: (423) 855-0001 | F: (423) 490-8662 | cblproperties.com | NYSE: CBL

LEASE PLAN
LEVEL THREE

PARK PLAZA MALL
6000 W. MARKHAM ST. LITTLE ROCK, ARKANSAS 72205
Phone: (312) 960-5000