

WEST MADISON BELTLINE U.S. HIGHWAY 12

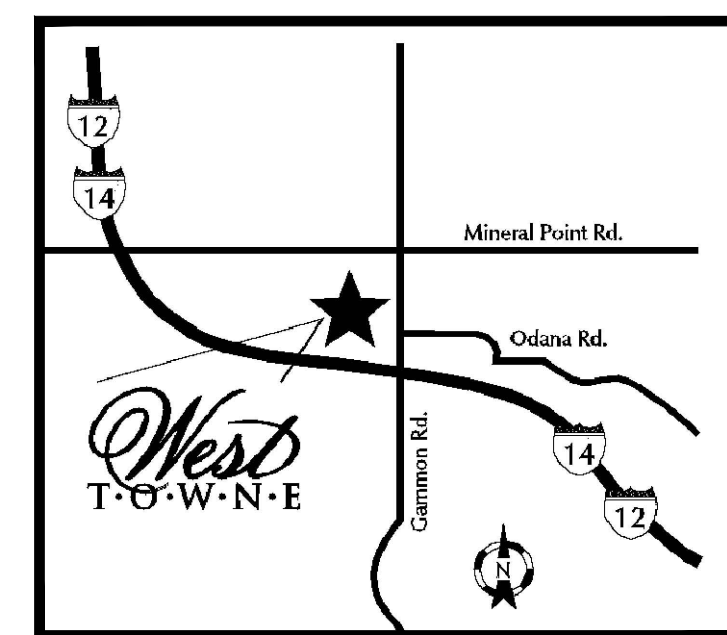

SITE LOCATION MAP

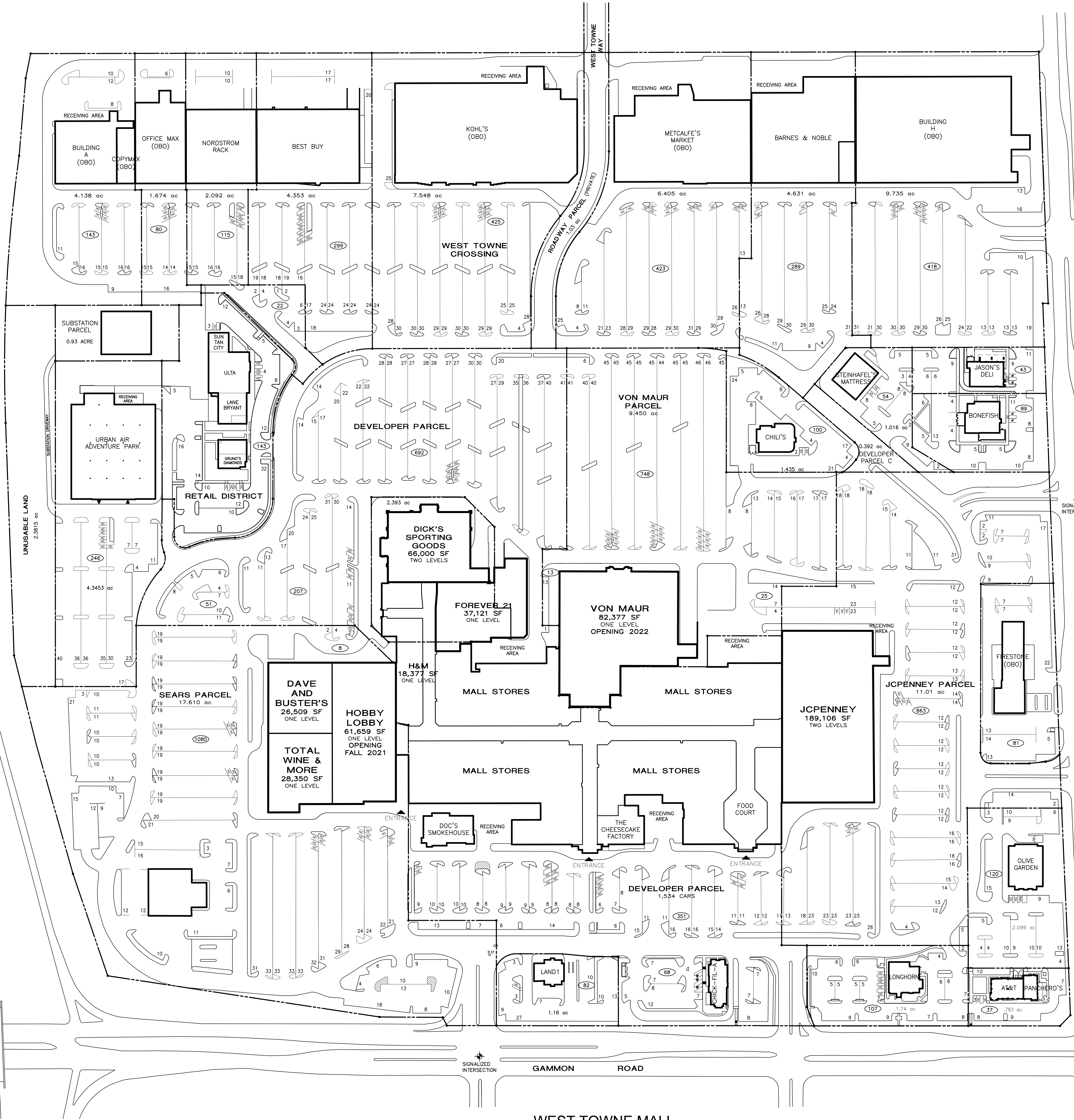
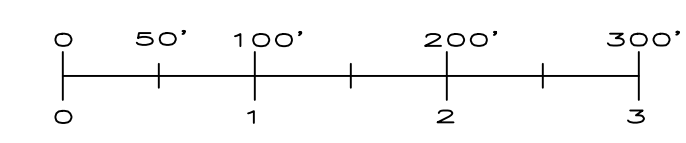

**LEGEND**  
 Δ ENTRANCE LOCATION  
 HC HANDICAP PARKING

**REVISIONS:**

10/01/2017	REVISED STATS
04/06/2018	REMOVED OBO FROM PAD-G. RESUBMITTED SEARS AND/OR REVISED STATS.
04/25/2018	MODIFIED OBO FOR BUILDING C. REVISED STATS.
08/17/2018	REVISED SQUARE FOOTAGES FOR SEARS BUILDING. REVISED STATS.
10/01/2018	REVISED STATS.
02/08/2019	OVERLAPED 2018 SURVEY CAD FILE. REVISED PARKING STATS.
04/01/2019	REMOVED OBO FROM BUILDING H. REVISED STATS.
10/01/2019	ADDED OBO TO PAD-G. REVISED STATS.
11/13/2019	FORMER BOSTON STORE PARCEL 200-12 DEVELOPER. REVISED STATS.
04/01/2020	REVISED STATS.
10/01/2020	REVISED STATS.

**CBL PROPERTIES**  
 CBL Center, Suite 500 | 2030 Hamilton Place Boulevard | Chattanooga, TN 37421-6000  
 P: (423) 855-0001 | F: (423) 490-8662 | cblproperties.com | NYSE: CBL

**CBL**  
**SITE PLAN**

**WEST TOWNE MALL**  
 66 WEST TOWNE MALL MADISON, WI 53719  
 PHONE: (608) 833-1544

SCALE: 1"=100'  
 REVISED BY: AYS  
 CAD FILENAME: WTSITE  
 DRAWING NUMBER: SP 1

JOB NUMBER:  
 IN-HOUSE DATE: 08/31/17

THIS PLAN SHALL NOT BE DEEMED TO BE A WARRANTY, REPRESENTATION OR AGREEMENT ON THE PART OF THE LANDLORD THAT THE SHOPPING CENTER WILL BE, OR WILL CONTINUE TO BE AS INDICATED HEREON WITHOUT CHANGE. LANDLORD MAY, FROM TIME TO TIME, INCREASE, REDUCE, AND/OR CHANGE THE PARKING AREAS OR COMMON AREAS AS LANDLORD SHALL DEEM PROPER. LANDLORD RESERVES THE RIGHT TO CHANGE THE GENERAL LAYOUT, AND TO MAKE ALTERATIONS AND ADDITIONS TO, AND TO BUILD ADDITIONAL STORIES ON THE BUILDING IN WHICH THE PREMISES ARE CONTAINED OR WHICH OTHERWISE COMPRISE THE SHOPPING CENTER AND TO MAKE ANY OTHER CHANGES AS MAY BE REQUIRED BY APPLICABLE CODE OR AUTHORITIES. THIS PLAN IS SUBJECT TO CHANGE, AND IS NOT A WARRANTY, REPRESENTATION OR AGREEMENT THAT PROSPECTIVE TENANTS OR ANCHOR STORES SHOWN HEREON WILL BE TENANTS OR ANCHOR STORES AT THE LOCATIONS SHOWN OR AT ANY OTHER LOCATION IN THE SHOPPING CENTER.