

SITE LOCATION MAP

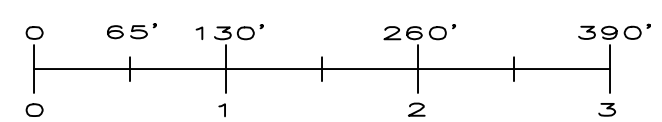

REVISIONS:

10/01/2010	REMOVED DBA FROM OUTPARCEL 8 & 10	REVISED STATUS
04/08/2011	REVISED STATUS	
04/09/2012	REVISED STATUS	
10/01/2012	REVISED STATUS	
04/08/2013	REVISED STATUS	
10/01/2013	REVISED STATUS	
04/01/2014	REVISED STATUS	
10/01/2014	REVISED STATUS	
04/06/2015	REVISED STATUS	
10/01/2015	REVISED STATUS	
02/11/2016	ADDED TENANT DEMING WALL IN THE LIFEWAY BLVD	
04/06/2016	REVISED STATUS	
10/01/2016	SOLD D'CHARLEY'S. REVISED STATUS. PURCHASED FORMER COUNTRY CITY PARCEL	
04/10/2017	REVISED STATUS	
07/02/2017	SOLD MENS WEARHOUSE. REVISED STATUS. REVISED STATUS	
10/01/2017	REVISED STATUS	
04/06/2018	REVISED STATUS	
10/01/2018	REMOVED DBA FROM OUTLA. REVISED STATUS	
04/01/2019	REVISED STATUS	

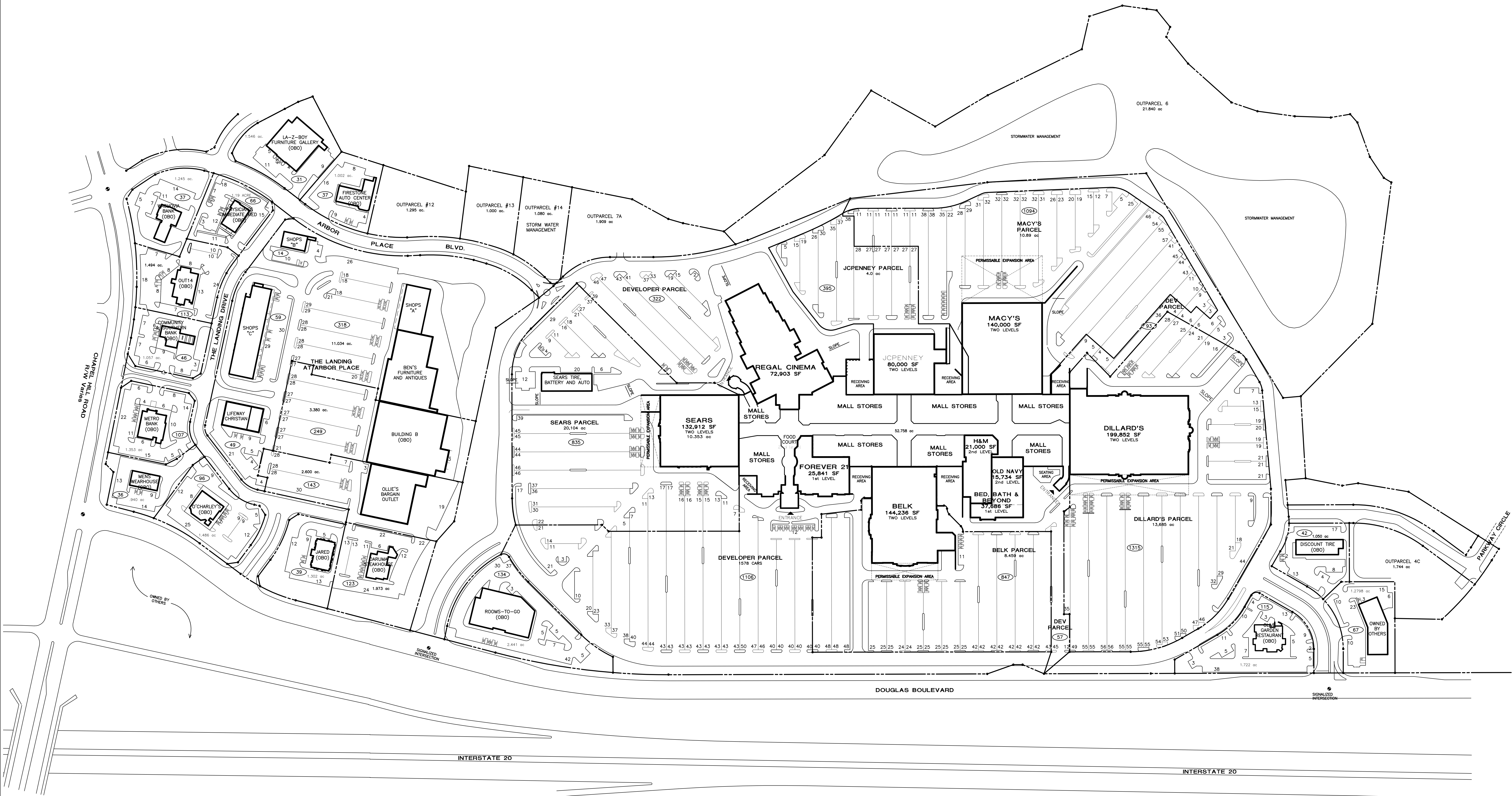

CBL PROPERTIES
 CBL Center, Suite 500 | 2030 Hamilton Place Boulevard | Chattanooga, TN 37421-0000
 P: (423) 855-0001 | F: (423) 490-8662 | cblproperties.com | NYSE: CBL

SITE PLAN

ARBOR PLACE
 6700 DOUGLAS BOULEVARD, DOUGLASVILLE, GEORGIA 30135
 PHONE: (770) 947-4244

SCALE:	1" = 130'	JOB NUMBER:	
REVISED BY:	AJS	IN-HOUSE DATE:	1/15/01
CAD FILENAME:	APSITE		
DRAWING NUMBER:			

ARBOR PLACE MALL

SP 1

THIS PLAN SHALL NOT BE DEEMED TO BE A WARRANTY, REPRESENTATION OR AGREEMENT ON THE PART OF THE LANDLORD THAT THE SHOPPING CENTER WILL BE, OR WILL CONTINUE TO BE AS INDICATED HEREON WITHOUT CHANGE. LANDLORD MAY, FROM TIME TO TIME, INCREASE, REDUCE, AND/OR CHANGE THE PARKING AREAS OR COMMON AREAS AS LANDLORD SHALL DEEM PROPER. LANDLORD RESERVES THE RIGHT TO CHANGE THE GENERAL LAYOUT, AND TO MAKE ALTERATIONS AND ADDITIONS TO, AND TO BUILD ADDITIONAL STORIES ON THE BUILDING IN WHICH THE PREMISES ARE CONTAINED OR WHICH OTHERWISE COMPRISE THE SHOPPING CENTER AND TO MAKE ANY OTHER CHANGES AS MAY BE REQUIRED BY APPLICABLE CODE OR AUTHORITIES. THIS PLAN IS SUBJECT TO CHANGE, AND IS NOT A WARRANTY, REPRESENTATION OR AGREEMENT THAT PROSPECTIVE TENANTS OR ANCHOR STORES SHOWN HEREON WILL BE TENANTS OR ANCHOR STORES AT THE LOCATIONS SHOWN OR AT ANY OTHER LOCATION IN THE SHOPPING CENTER.