

DILLARD'S WEST
WOMEN & HOME
TWO LEVELS

6700
96,625sf
*TOTAL FLOOR AREA = 193,250sf

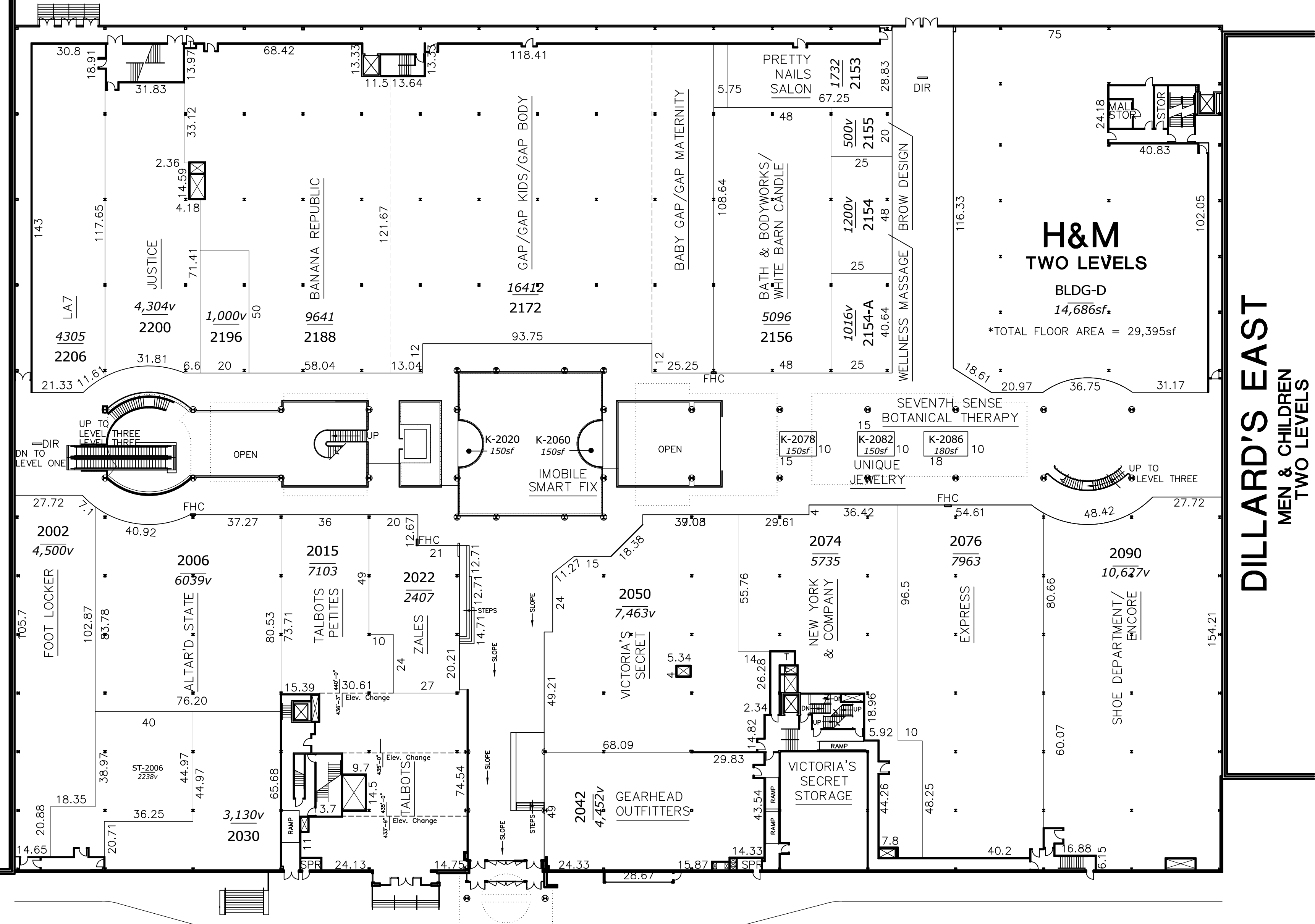

6701
42,787sf
*TOTAL FLOOR AREA = 85,574sf

DILLARD'S EAST
MEN & CHILDREN
TWO LEVELS

PARK PLAZA MALL

REVISIONS:

NO CHANGES.				
REVISED DBA FOR 2042, REMOVED DBA FROM 2006 TO 2074, REMOVED DBA FORM 2090, NY: NEW 2 LEVEL H&M RECONFIG 2002 FOR NEW DBA, NEW DBA IN 2153, 2155.	029	M/SB	028	10/01/2016
REMOVED DBA FROM 2154.	030	DDL	029	04/10/2017
ADDED DBA TO 2090, 2006, 2206, REMOVED DBA FROM 2008, 2196, REFINED BLDG D SF PER YARDI.	031	M/SB	030	04/08/2018
REVISED DBA FOR 2206, 2042, K-2020, K-2060, SPLIT 2154 FOR NEW DBA, COMBINED 2006 2008 FOR NEW DBA ADDED NEW ST-2006.	032	M/SB	031	10/01/2018
MOVED DBA FROM 2154-A TO K-2060, REMOVED DBA FROM K-2020, 2030, ADDED DBA TO K-2108, REVISED DBA FOR 2154.	033	M/SB	032	04/01/2019

CBL PROPERTIES
CBL Center, Suite 500 | 2030 Hamilton Place Boulevard | Chattanooga, TN 37421-6000
P: (423) 855-0001 | F: (423) 490-8662 | cblproperties.com | NYSE: CBL

LEASE PLAN
LEVEL TWO

PARK PLAZA MALL
6000 W. MARKHAM ST., LITTLE ROCK, ARKANSAS 72205
Phone: (312) 960-5000

LEGEND

DIR - MALL DIRECTORY	MINT - MAINTENANCE RM
STO - MALL STORAGE	ELEV - ELEVATOR
TRAN - TRANSFORMER	EER - ELEV EQUIP RM
LCK - LOCKERS	SPR - SPRINKLER RM
JCL - JANITOR CLOSET	ELEC - ELECTRICAL RM
COMP - COMPACTOR	SGR - SWITCH GEAR RM

SCALE: 1" = 30'

REVISIONS: DDL

EXHIBIT PRINTING DATE: 04/01/2019

2217 SQ FT B-04 UNIT #

JOB NUMBER: 06/22/2004

IN-HOUSE DATE: PALP2

CAD FILENAME: LP 2

DRAWING NUMBER: LP 2

THIS PLAN SHALL NOT BE DEEMED TO BE A WARRANTY, REPRESENTATION OR AGREEMENT ON THE PART OF THE LANDLORD THAT THE SHOPPING CENTER WILL BE, OR WILL CONTINUE TO BE AS INDICATED HEREON WITHOUT CHANGE. LANDLORD MAY, FROM TIME TO TIME, INCREASE, REDUCE, AND/OR CHANGE THE PARKING AREAS OR COMMON AREAS AS LANDLORD SHALL DEEM PROPER. LANDLORD RESERVES THE RIGHT TO CHANGE THE GENERAL LAYOUT, AND TO MAKE ALTERATIONS AND ADDITIONS TO, AND TO BUILD ADDITIONAL STORIES ON THE BUILDING IN WHICH THE PREMISES ARE CONTAINED OR WHICH OTHERWISE COMPRISE THE SHOPPING CENTER AND TO MAKE ANY OTHER CHANGES AS MAY BE REQUIRED BY APPLICABLE CODE OR AUTHORITIES. THIS PLAN IS SUBJECT TO CHANGE, AND IS NOT A WARRANTY, REPRESENTATION OR AGREEMENT THAT PROSPECTIVE TENANTS OR ANCHOR STORES SHOWN HEREON WILL BE TENANTS OR ANCHOR STORES AT THE LOCATIONS SHOWN OR AT ANY OTHER LOCATION IN THE SHOPPING CENTER.