

SIGNALIZED INTERSECTION

CHERRYVALE NORTH BLVD.

PAWLISCH DRIVE

PERRYVILLE ROAD

BELL SCHOOL ROAD

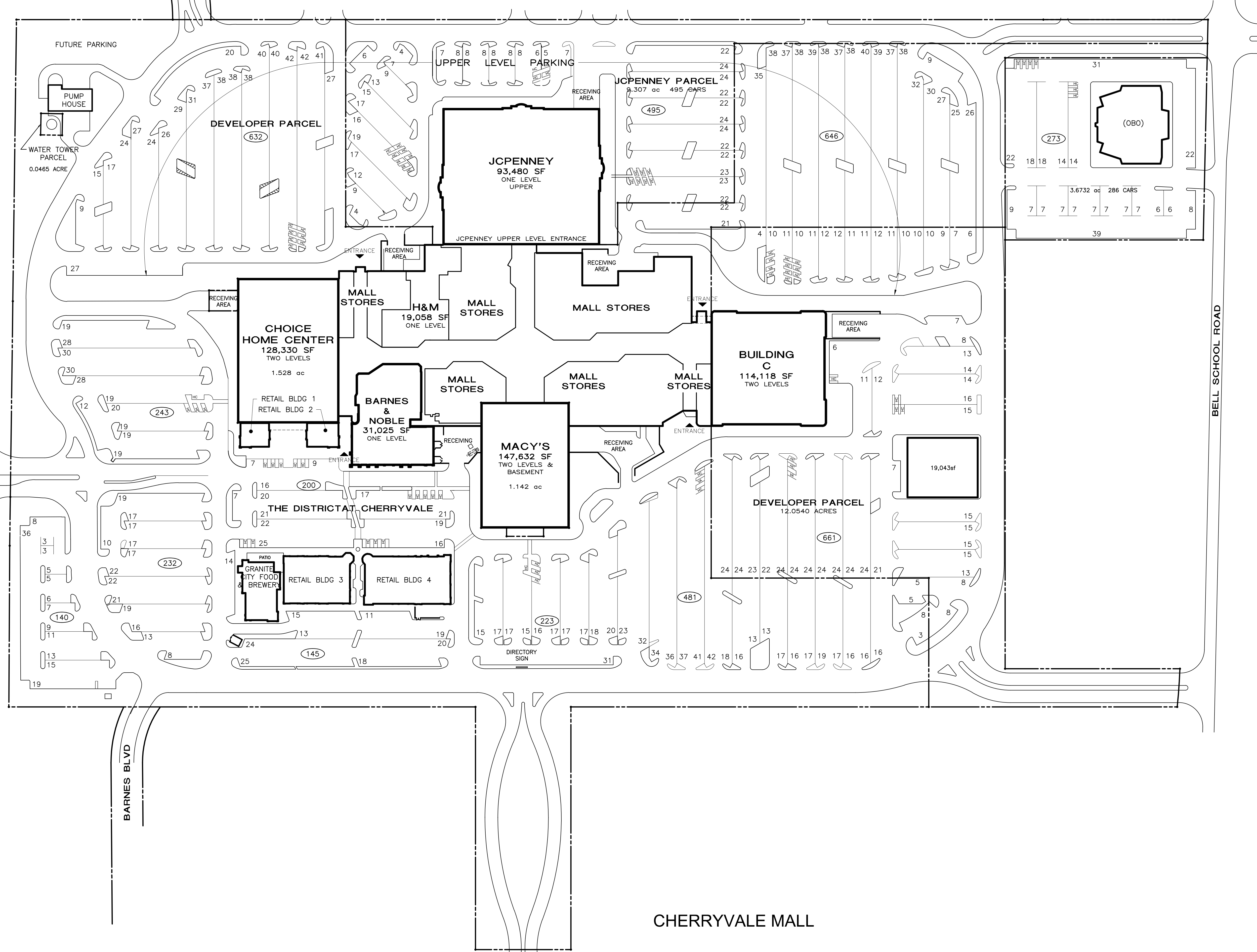

### CHERRYVALE MALL

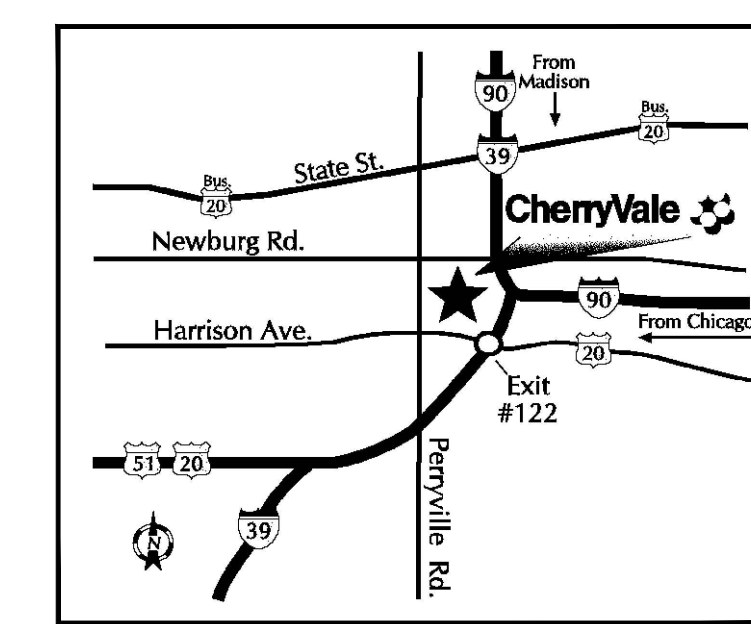

SITE LOCATION MAP

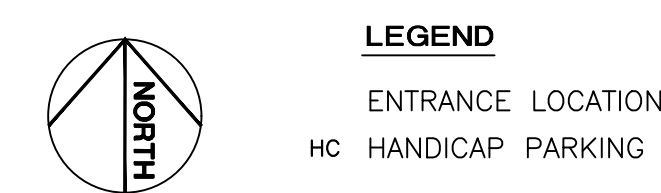
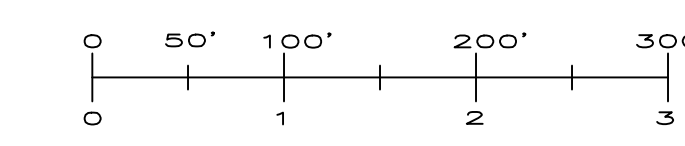

REVISIONS:	DATE	DESCRIPTION
04/09/2012	REVISED	STATS
10/01/2012	REVISED	STATS
04/08/2013	REVISED	STATS
10/01/2013	REVISED	STATS
04/07/2014	REVISED	STATS
10/01/2014	REVISED	STATS
04/06/2015	REVISED	STATS
10/01/2015	REVISED	STATS
04/06/2016	REVISED	STATS
10/01/2016	REVISED	STATS
04/10/2017	REVISED	STATS
10/01/2017	REVISED	STATS
04/06/2018	REVISED	STATS
04/25/2018	MODIFIED IDIA FOR BUILDING A. REVISED STATS.	
10/01/2018	REVISED	STATS
04/01/2019	ADDED IDIA TO BUILDING A. REVISED IDIA FROM BUILDING C. REVISED STATS.	

**CBL**  
**CBL PROPERTIES**  
 CBL Center, Suite 500 | 2030 Hamilton Place Boulevard | Chattanooga, TN 37421-6000  
 P: (423) 855-0001 | F: (423) 496-8662 | cblproperties.com | NYSE: CBL

## SITE PLAN

**CHERRYVALE MALL**  
 7200 HARRISON, SUITE 5 | ROCKFORD, IL 61112-1017  
 Phone: (815) 332-2451

SCALE: 1"=100'	JOB NUMBER:
REVISED BY: AYS	IN-HOUSE DATE: 04/20/01
CAD FILENAME: CVSITE	DRAWING NUMBER:

## SP 1

THIS PLAN SHALL NOT BE DEEMED TO BE A WARRANTY, REPRESENTATION OR AGREEMENT ON THE PART OF THE LANDLORD THAT THE SHOPPING CENTER WILL BE, OR WILL CONTINUE TO BE AS INDICATED HEREON WITHOUT CHANGE. LANDLORD MAY, FROM TIME TO TIME, INCREASE, REDUCE, AND/OR CHANGE THE PARKING AREAS OR COMMON AREAS AS LANDLORD SHALL DEEM PROPER. LANDLORD RESERVES THE RIGHT TO CHANGE THE GENERAL LAYOUT, AND TO MAKE ALTERATIONS AND ADDITIONS TO, AND TO BUILD ADDITIONAL STORIES ON THE BUILDING IN WHICH THE PREMISES ARE CONTAINED OR WHICH OTHERWISE COMPRISE THE SHOPPING CENTER AND TO MAKE ANY OTHER CHANGES AS MAY BE REQUIRED BY APPLICABLE CODE OR AUTHORITIES. THIS PLAN IS SUBJECT TO CHANGE, AND IS NOT A WARRANTY, REPRESENTATION OR AGREEMENT THAT PROSPECTIVE TENANTS OR ANCHOR STORES SHOWN HEREON WILL BE TENANTS OR ANCHOR STORES AT THE LOCATIONS SHOWN OR AT ANY OTHER LOCATION IN THE SHOPPING CENTER.