

REVISIONS:	DATE	BY
ADDED DBA TO KK-20. UPDATED DBA ON 426.	10/01/2018	031 M/SB
ADDED DBA TO KK-97. 108. REVISED DBA FOR 366. REMOVED DBA FROM 200, 426, 538, 204, 249, KK-80, 344, 434, KK-20, KK-95.	04/01/2019	032 M/SB
ADDED PK-110 FOR NEW DBA. ADDED DBA TO 249, 426, 532, 538 & 578. REMOVED DBA FROM 378, 402, 542 & KK-97. REVISED DBA FOR 108.	10/01/2019	033 JAB
REVISED DBA FOR 366. REMOVED DBA FROM 124, 145, 212, 304, 398 & 538. ADDED DBA TO 422 & 434.	04/01/2020	034 JAB
ADDED DBA TO 112 & 542. REVISED DBA FOR 570 & 136. REMOVED DBA FROM 320, 344, 434, 153, 396 & 543.	10/01/2020	035 AYS

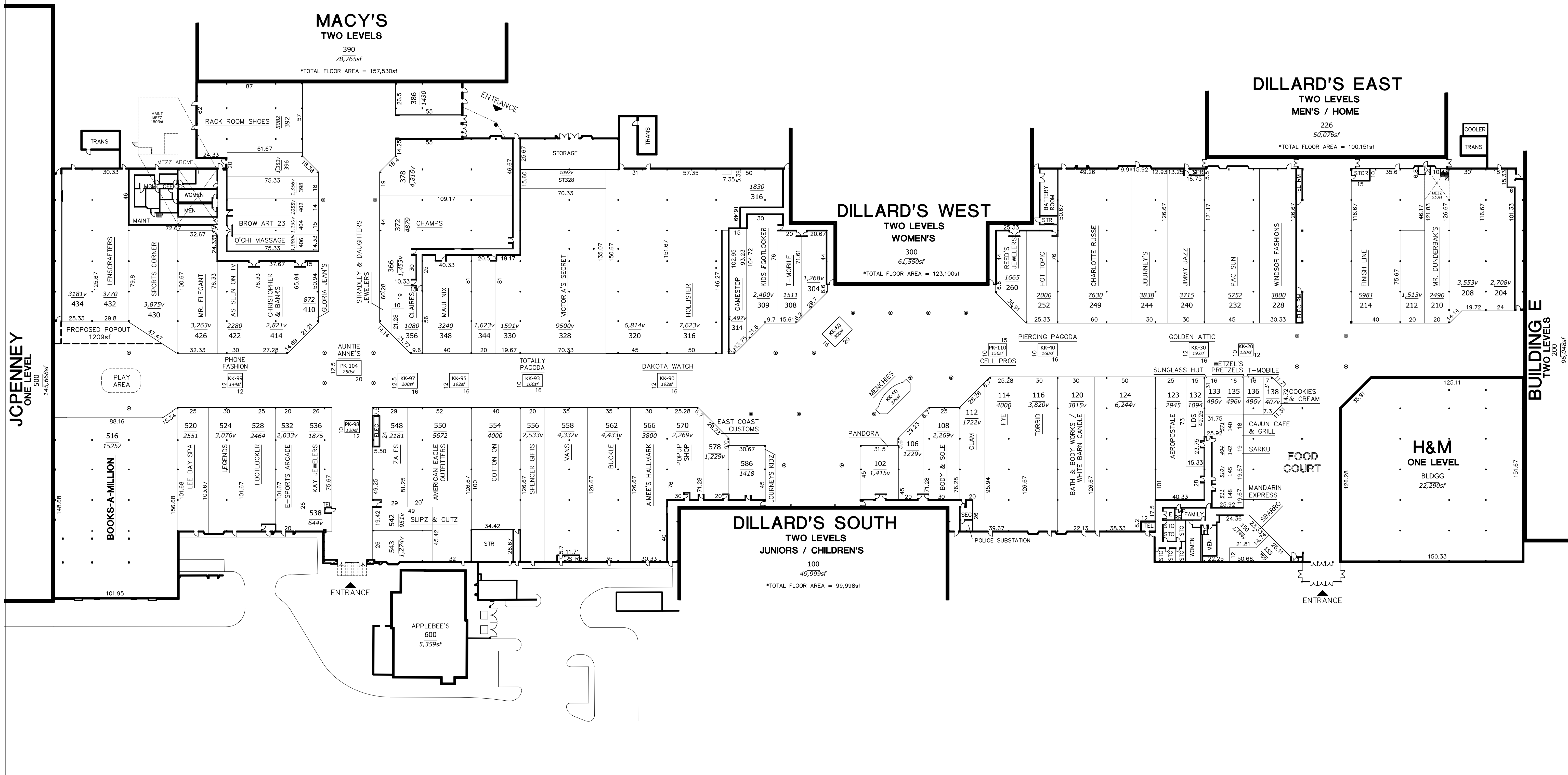

CBL PROPERTIES
 CBL Center, Suite 500 | 2030 Hamilton Place Boulevard | Chattanooga, TN 37421-6000
 P: (423) 855-0001 | F: (423) 490-8662 | cblproperties.com | NYSE: CBL

LEASE PLAN

VOLUSIA MALL
 1700 W. INT'L SPEEDWAY BLVD., DAKOTINA BEACH, FL 32114
 PHONE: (386) 205-6706

LEGEND
 DIR - MALL DIRECTORY
 STO - MALL STORAGE
 TRAN - TRANSFORMER
 LCK - LOCKERS
 JCL - JANITOR CLOSET
 COMP - COMPACTOR
 MNT - MAINTENANCE RM
 ELEV - ELEVATOR
 EER - ELEV EQUIP RM
 SPR - SPRINKLER RM
 ELEC - ELECTRICAL RM
 SGR - SWITCH GEAR RM

SCALE: 1" = 40'
 JOB NUMBER:
 REVISED BY: AYS
 IN-HOUSE DATE: 02/11/2004
 CAD FILENAME: VOLP1
 DRAWING NUMBER:
 EXHIBIT PRINTING DATE: 10/01/2020
 2217 SQ FT B-04 UNIT #

0 20' 40' 80' 120'
 1 2 3

NORTH

THIS PLAN SHALL NOT BE DEEMED TO BE A WARRANTY, REPRESENTATION OR AGREEMENT ON THE PART OF THE LANDLORD THAT THE SHOPPING CENTER WILL BE, OR WILL CONTINUE TO BE AS INDICATED HEREON WITHOUT CHANGE. LANDLORD MAY, FROM TIME TO TIME, INCREASE, REDUCE, AND/OR CHANGE THE PARKING AREAS OR COMMON AREAS AS LANDLORD SHALL DEEM PROPER. LANDLORD RESERVES THE RIGHT TO CHANGE THE GENERAL LAYOUT, AND TO MAKE ALTERATIONS AND ADDITIONS TO, AND TO BUILD ADDITIONAL STORIES ON THE BUILDING IN WHICH THE PREMISES ARE CONTAINED OR WHICH OTHERWISE COMPRISE THE SHOPPING CENTER AND TO MAKE ANY OTHER CHANGES AS MAY BE REQUIRED BY APPLICABLE CODE OR AUTHORITIES. THIS PLAN IS SUBJECT TO CHANGE, AND IS NOT A WARRANTY, REPRESENTATION OR AGREEMENT THAT PROSPECTIVE TENANTS OR ANCHOR STORES SHOWN HEREON WILL BE TENANTS OR ANCHOR STORES AT THE LOCATIONS SHOWN OR AT ANY OTHER LOCATION IN THE SHOPPING CENTER.

VOLUSIA MALL