

**BUILDING A
TWO LEVELS**

ANCHORAZ
89,000sf

*TOTAL FLOOR AREA = 178,000sf

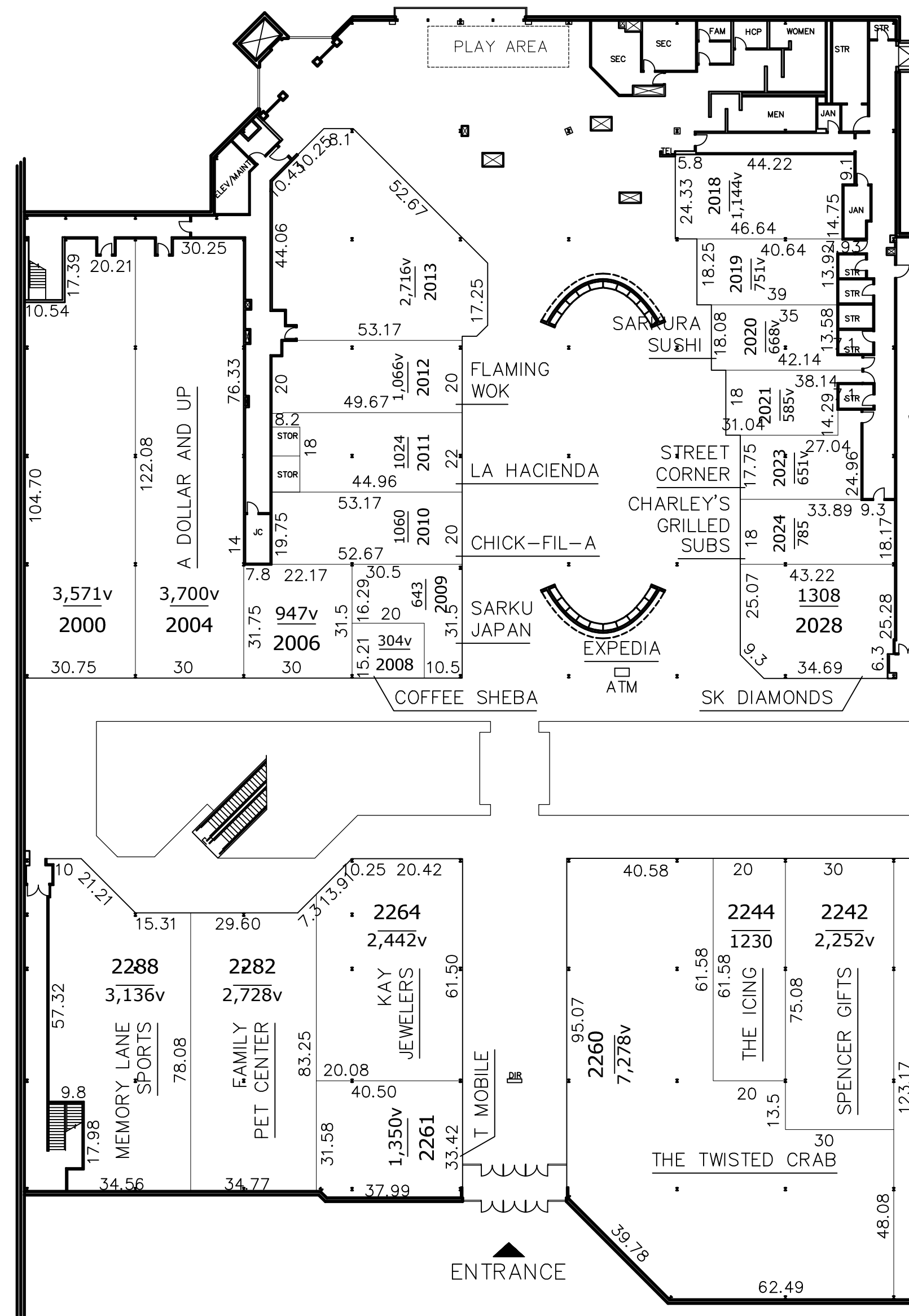

**JCPENNEY
TWO LEVELS**

002M2
52,630sf

*TOTAL FLOOR AREA = 105,260sf

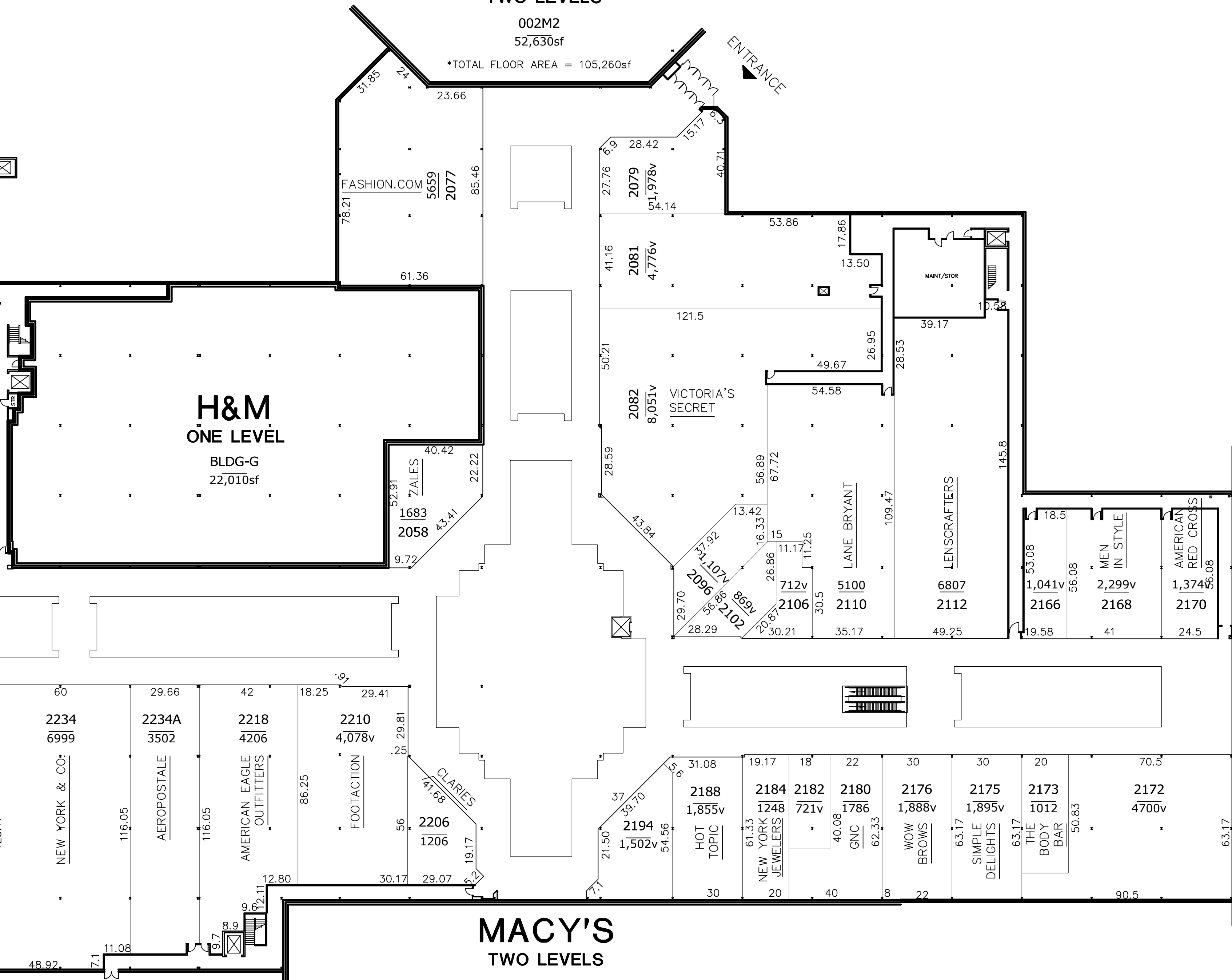

**MACY'S
TWO LEVELS**

ANCHORD2
70,361sf

*TOTAL FLOOR AREA = 140,722sf

**DILLARD'S
TWO LEVELS**

ANCHORC2
80,000sf

*TOTAL FLOOR AREA = 160,000sf

REVISIONS:

ADDED DBA TO 2013, 2019, 2194, REMOVED DBA FROM 2260.	032	DDL	08/04/2017
ADDED DBA TO 2106	033	M/SB	10/01/2017
ADDED DBA FOR 2096, REVISED DBA FOR 2028, REMOVED DBA FROM 2006, 2021.	034	M/SB	04/06/2018
ADDED DBA TO 2170, REVISED DBA FRO ANCHORAZ, REMOVED DBA FROM 2019, 2106, 2172, 2182.	035	M/SB	10/01/2018
ADDED DBA TO 2260, REMOVED DBA FROM 2000, 2102, 2096, 2081, 2013, 2166 & 2194.	036	M/SB	04/01/2019

CBL PROPERTIES
CBL Center, Suite 500 | 2030 Hamilton Place Boulevard | Chattanooga, TN 37421-6000
P: (423) 855-0001 | F: (423) 490-8662 | cblproperties.com | NYSE: CBL

**LEASE PLAN
UPPER LEVEL**

GREENBRIER MALL
1401 GREENBRIER PARKWAY
PHONE CHESAPEAKE, VA

LEGEND

DIR - MALL DIRECTORY	MNT - MAINTENANCE RM
STO - MALL STORAGE	ELEV - ELEVATOR
TRAN - TRANSFORMER	EER - ELEV EQUIP RM
LOCK - LOCKERS	SPR - SPRINKLER RM
JCL - JANITOR CLOSET	ELEC - ELECTRICAL RM
COMP - COMPACTOR	SGR - SWITCH GEAR RM

SCALE: 1" = 30'

REVISIONS: DDL 04/05/2004

EXHIBIT PRINTING DATE: 04/01/2019

2217 SQ FT B-04 UNIT #

CAO FILENAME: GRLP2

DRAWING NUMBER: LP 2

GREENBRIER MALL

THIS PLAN SHALL NOT BE DEEMED TO BE A WARRANTY, REPRESENTATION OR AGREEMENT ON THE PART OF THE LANDLORD THAT THE SHOPPING CENTER WILL BE, OR WILL CONTINUE TO BE AS INDICATED HEREON WITHOUT CHANGE. LANDLORD MAY, FROM TIME TO TIME, INCREASE, REDUCE, AND/OR CHANGE THE PARKING AREAS OR COMMON AREAS AS LANDLORD SHALL DEEM PROPER. LANDLORD RESERVES THE RIGHT TO CHANGE THE GENERAL LAYOUT, AND TO MAKE ALTERATIONS AND ADDITIONS TO, AND TO BUILD ADDITIONAL STORIES ON THE BUILDING IN WHICH THE PREMISES ARE CONTAINED OR WHICH OTHERWISE COMPRISE THE SHOPPING CENTER AND TO MAKE ANY OTHER CHANGES AS MAY BE REQUIRED BY APPLICABLE CODE OR AUTHORITIES. THIS PLAN IS SUBJECT TO CHANGE, AND IS NOT A WARRANTY, REPRESENTATION OR AGREEMENT THAT PROSPECTIVE TENANTS OR ANCHOR STORES SHOWN HEREON WILL BE TENANTS OR ANCHOR STORES AT THE LOCATIONS SHOWN OR AT ANY OTHER LOCATION IN THE SHOPPING CENTER.