

REVISIONS:			
MODIFIED DBA FOR 1330, REMOVED DBA FROM 1220.	034	N	04/25/2018
ADDED DBA FOR 1235, SPLIT 1130 & 1135 FOR NEW DBA. REMOVED DBA FROM 1180, 1070.	035	M	10/01/2018
ADDED DBA FOR 1030 & 1425. REVISED DBA FOR 1474. REMOVED DBA FROM 1050, 1140, 1250, 1265-70, 1445, 1460 & 1470.	036	L	04/07/2019
REVISED DBA FROM 1485, REMOVED DBA FROM 1040 & 1474.	037	N	10/01/2019
ADD DBA TO 1445, REVISED DBA FOR 1425. REMOVED DBA FROM K-1555, K-1565, 2560, 1255, 1474, 1030, 1040, 1430, 1465 & 1487.	038	M	04/07/2020
REMOVED DBA FROM 1177, 1185, 1280-85, 1315 & 1420. ADDED DBA TO 1130 & 1487.	039	J	10/01/2020

CBL Center, Suite 500 | 2030 Hamilton Place Boulevard | Chattanooga, TN 37421-6000
 P. (423) 855-0001 F. (423) 490-8662 | cblproperties.com | NYSE: CBL



LEASE PLAN

EASTLAND MALL
 1615 EAST EMPIRE STREET | BLOOMINGTON, IL 61701
 Phone: (309) 663-5361

SCALE: 1" = 40'	JOB NUMBER:
REVISED BY: DDL	IN-HOUSE DATE: 10/18/2005
CAD FILENAME: ELLP1	DRAWING NUMBER: LP 1

LEGEND

DIR - MALL DIRECTORY	MNT - MAINTENANCE RM
STO - MALL STORAGE	ELEV - ELEVATOR
TRAN - TRANSFORMER	EER - ELEV EQUIP RM
LCK - LOCKERS	SPR - SPRINKLER RM
JCL - JANITOR CLOSET	ELEC - ELECTRICAL RM
COMP - COMPACTOR	SGR - SWITCH GEAR RM

2217 SQ FT
 B-04 UNIT #

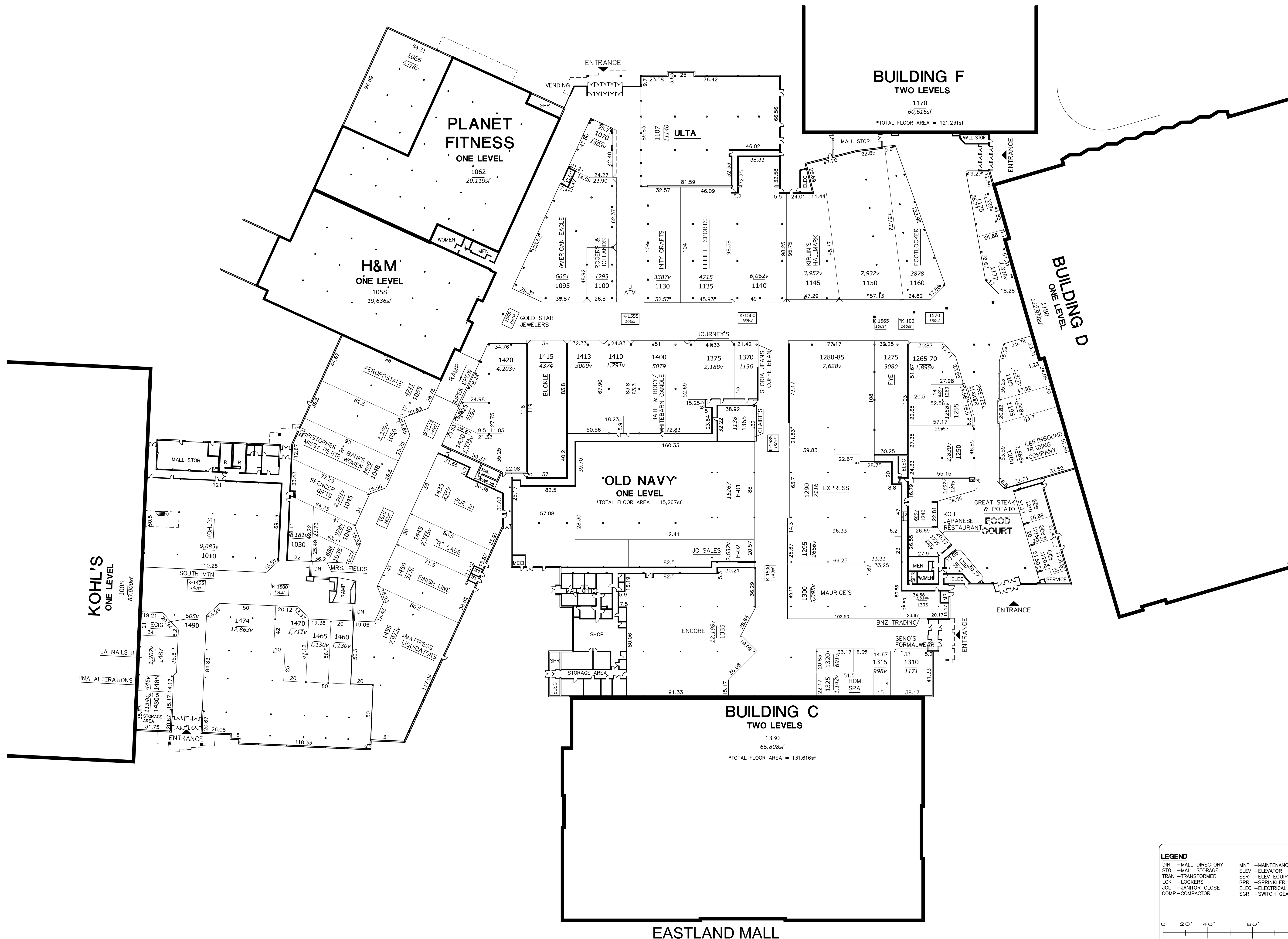

THIS PLAN SHALL NOT BE DEEMED TO BE A WARRANTY, REPRESENTATION OR AGREEMENT ON THE PART OF THE LANDLORD THAT THE SHOPPING CENTER WILL BE, OR WILL CONTINUE TO BE AS INDICATED HEREON WITHOUT CHANGE. LANDLORD MAY, FROM TIME TO TIME, INCREASE, REDUCE, AND/OR CHANGE THE PARKING AREAS OR COMMON AREAS AS LANDLORD SHALL DEEM PROPER. LANDLORD RESERVES THE RIGHT TO CHANGE THE GENERAL LAYOUT, AND TO MAKE ALTERATIONS AND ADDITIONS TO, AND TO BUILD ADDITIONAL STORIES ON THE BUILDING IN WHICH THE PREMISES ARE CONTAINED OR WHICH OTHERWISE COMPRISE THE SHOPPING CENTER AND TO MAKE ANY OTHER CHANGES AS MAY BE REQUIRED BY APPLICABLE CODE OR AUTHORITIES. THIS PLAN IS SUBJECT TO CHANGE, AND IS NOT A WARRANTY, REPRESENTATION OR AGREEMENT THAT PROSPECTIVE TENANTS OR ANCHOR STORES SHOWN HEREON WILL BE TENANTS OR ANCHOR STORES AT THE LOCATIONS SHOWN OR AT ANY OTHER LOCATION IN THE SHOPPING CENTER.