

**BUILDING A**  
TWO LEVELS

ANCHORA  
89,000sf  
\*TOTAL FLOOR AREA = 178,000sf

**JCPENNEY**  
TWO LEVELS

002M  
52,630sf  
\*TOTAL FLOOR AREA = 105,260sf

**DILLARD'S**  
TWO LEVELS

ANCHORC  
80,000sf  
\*TOTAL FLOOR AREA = 160,000sf

**MACY'S**  
TWO LEVELS

ANCHORD  
70,361sf  
\*TOTAL FLOOR AREA = 140,722sf

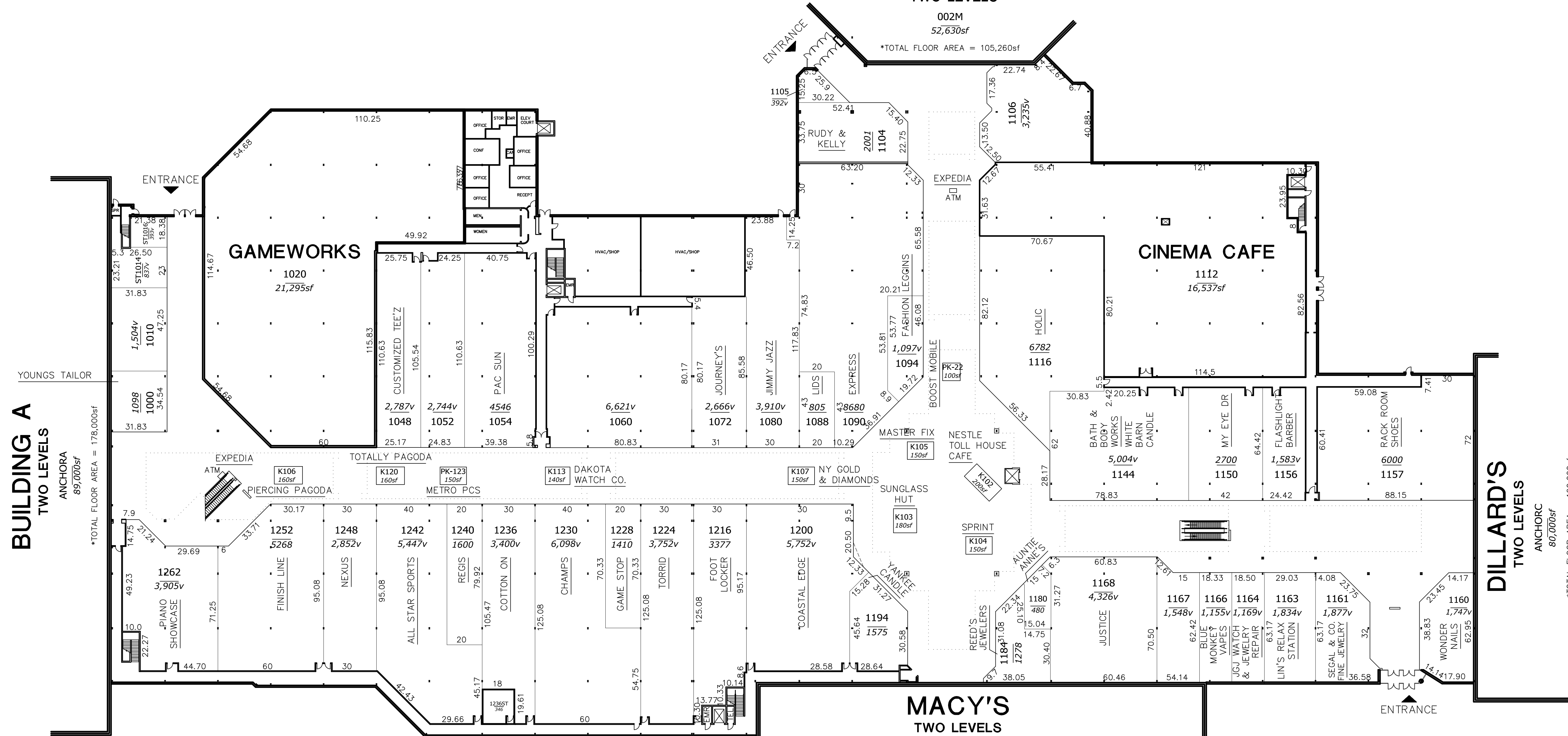

REVISIONS:

ADDED DBA TO 1010, REVISED DBA FOR 1088, REMOVED DBA FROM 1116.	028	DDL	04/10/2017
NY: ADDED DBA TO 1080, 1230.	029	DDL	08/04/2017
ADDED DBA TO 1156, REVISED DBA FOR K120, 1200, 1166, 1164, 1161, 1150, REMOVED DBA FROM 1242.	030	N/JSB	10/01/2017
ADDED DBA TO 1167, REMOVED DBA FROM 1248.	031	N/JSB	10/01/2017
ADDED DBA TO 1116, MOVED DBA FROM 1167 TO 1242, REMOVED PK-125 PER MALL MGR (NOT ENOUGH ROOM PER CODE).	032	N/JSB	04/06/2018
ADDED DBA TO PK-22, REVISED DBA FOR K102 AND K105, REVISED DBA FOR ANCHORA, REMOVED DBA FROM 1052, 1242, 1010.	033	N/JSB	10/07/2018
ADDED DBA TO 1248, 1242, 1094, REVISED DBA FOR PK-22, 1156, 1163, REMOVED DBA FROM 1060.	033	N/JSB	10/07/2019

**CBL PROPERTIES**  
CBL Center, Suite 500 | 2030 Hamilton Place Boulevard | Chattanooga, TN 37421-6000  
P: (423) 855-0001 | F: (423) 490-8662 | cblproperties.com | NYSE: CBL

**LEASE PLAN**  
LOWER LEVEL

**GREENBRIER MALL**  
1401 GREENBRIER PARKWAY  
PHONE CHESAPEAKE, VA

**LEGEND**

DIR - MALL DIRECTORY	MNT - MAINTENANCE RM
STO - MALL STORAGE	ELEV - ELEVATOR
TRAN - TRANSFORMER	EER - ELEV EQUIP RM
LCK - LOCKERS	SPR - SPRINKLER RM
JCL - JANITOR CLOSET	ELEC - ELECTRICAL RM
COMP - COMPACTOR	SGR - SWITCH GEAR RM

SCALE: 1" = 30'

REVISIONS: DDL 04/05/2004

EXHIBIT PRINTING DATE: 04/01/2019

2217 SQ FT  
B-04 UNIT #

CAD FILENAME: GRP1

DRAWING NUMBER: LP 1

0 15' 30' 60' 90'

NORTH

**GREENBRIER MALL**

THIS PLAN SHALL NOT BE DEEMED TO BE A WARRANTY, REPRESENTATION OR AGREEMENT ON THE PART OF THE LANDLORD THAT THE SHOPPING CENTER WILL BE, OR WILL CONTINUE TO BE AS INDICATED HEREON WITHOUT CHANGE. LANDLORD MAY, FROM TIME TO TIME, INCREASE, REDUCE, AND/OR CHANGE THE PARKING AREAS OR COMMON AREAS AS LANDLORD SHALL DEEM PROPER. LANDLORD RESERVES THE RIGHT TO CHANGE THE GENERAL LAYOUT, AND TO MAKE ALTERATIONS AND ADDITIONS TO, AND TO BUILD ADDITIONAL STORIES ON THE BUILDING IN WHICH THE PREMISES ARE CONTAINED OR WHICH OTHERWISE COMPRISE THE SHOPPING CENTER AND TO MAKE ANY OTHER CHANGES AS MAY BE REQUIRED BY APPLICABLE CODE OR AUTHORITIES. THIS PLAN IS SUBJECT TO CHANGE, AND IS NOT A WARRANTY, REPRESENTATION OR AGREEMENT THAT PROSPECTIVE TENANTS OR ANCHOR STORES SHOWN HEREON WILL BE TENANTS OR ANCHOR STORES AT THE LOCATIONS SHOWN OR AT ANY OTHER LOCATION IN THE SHOPPING CENTER.