

REVISIONS:	
10/01/2010	REVISED STATS
04/08/2011	REVISED STATS
10/01/2011	REVISED STATS
12/13/2011	REVISED PERIMETER FOOTPRINT AND PARKING LAYOUT PER AERIAL PHOTO. REVISED STATS
04/09/2012	REVISED STATS
10/01/2012	REVISED STATS
04/08/2013	REVISED STATS
10/01/2013	REVISED STATS
04/07/2014	REVISED STATS
10/01/2014	ADDED H&M. REVISED STATS
04/06/2015	ADDED ACCESS ELEMENT TO PARCEL C-2A. REVISED STATS
10/01/2015	REVISED STATS
04/06/2016	REVISED STATS
10/01/2016	REVISED STATS
04/10/2017	REVISED STATS
10/01/2017	REVISED STATS
04/06/2018	REVISED OUT PARKING LAYOUT PER AERIAL PHOTO. REVISED STATS
04/23/2018	EXPANDED F-1 BUILDING BY 10,000 SF. REVISED F-1+300 PARCEL FOR 2018 REPLAT. REVISED STATS
10/01/2018	REVISED STATS
04/01/2019	ADDED HOTEL TO PARCEL C-2A. REVISED STATS
10/01/2019	ADDED DSG AND CHANGEL PAD TO DEVELOPER PARCEL. REVISED STATS
4/01/2020	REVISED STATS
10/01/2020	REVISED STATS

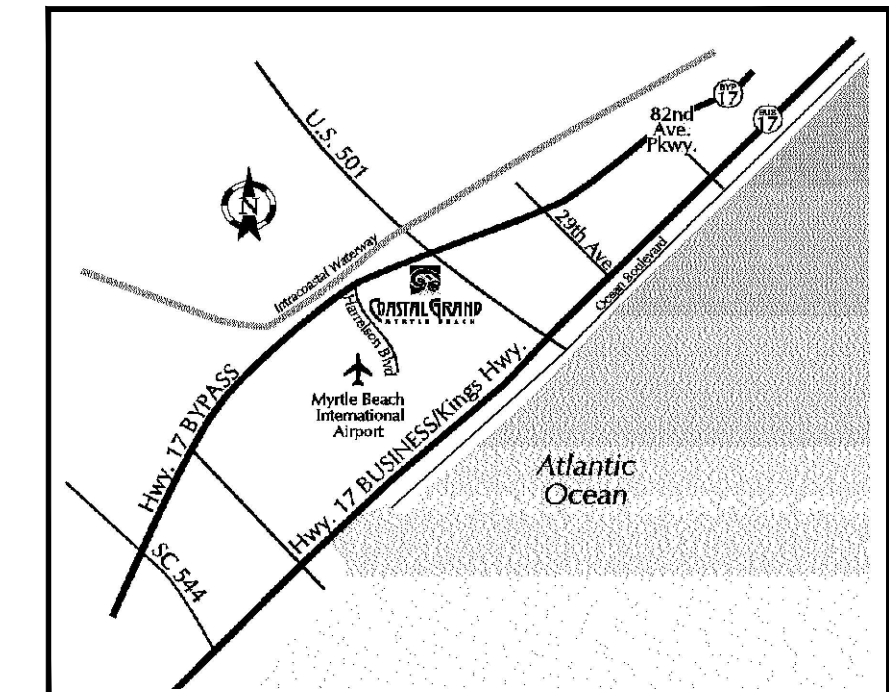

SITE LOCATION MAP

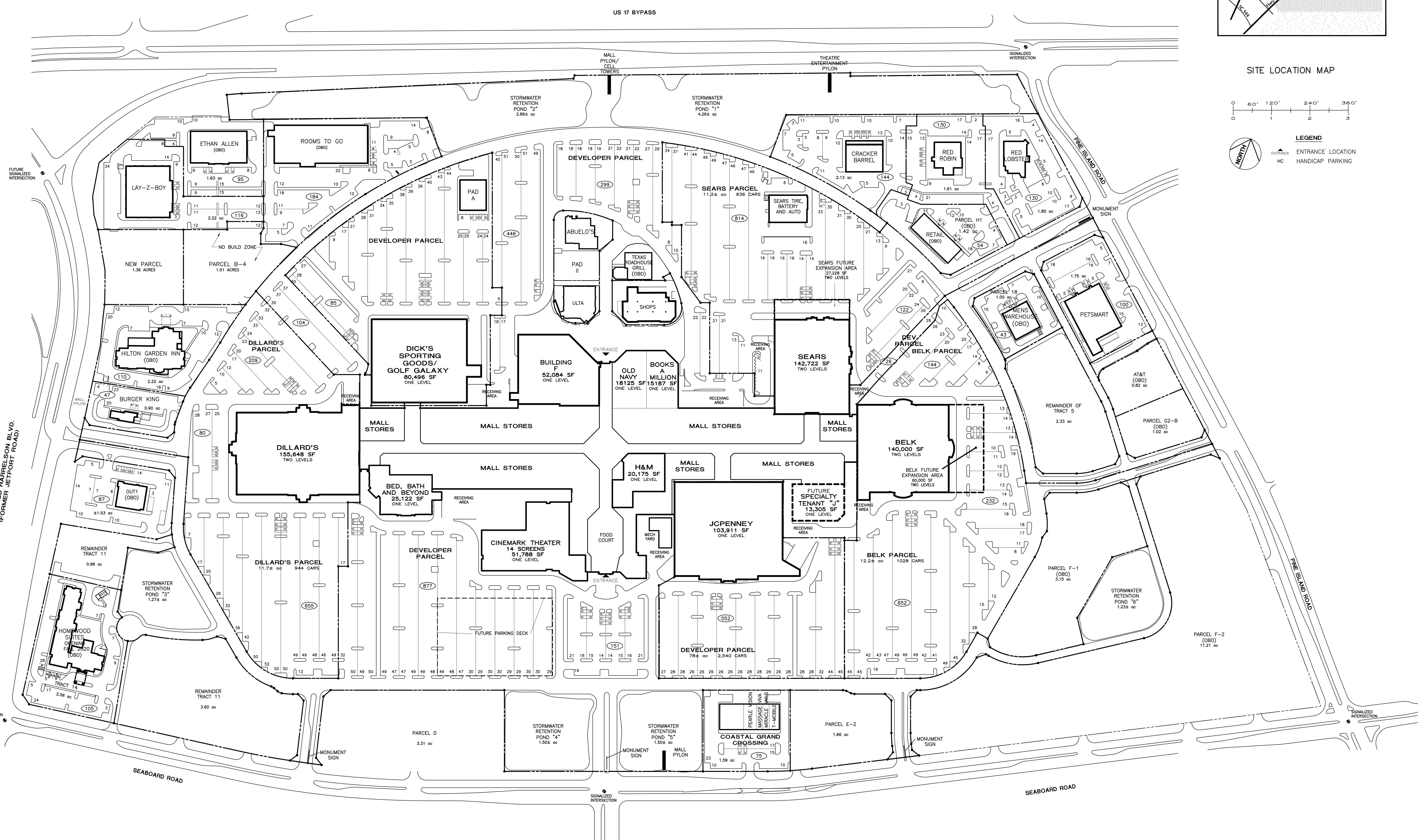
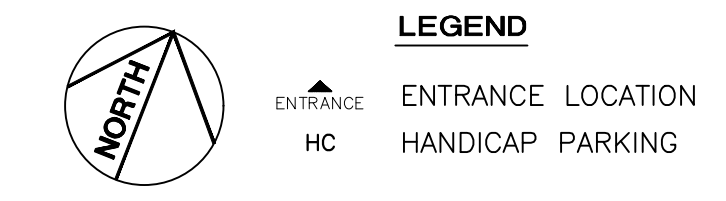
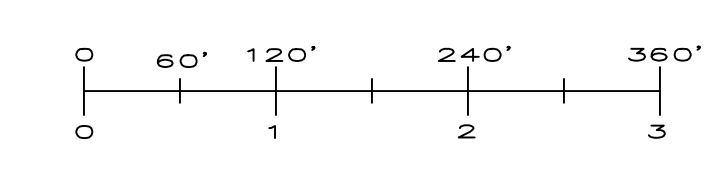

COASTAL GRAND

CBL
CBL PROPERTIES
 CBL Center, Suite 500 2030 Hamilton Place Boulevard Chattanooga, TN 37421-6000
 P: (423) 855-0001 F: (423) 496-8662 | cblproperties.com | NYSE: CBL

SITE PLAN

COASTAL GRAND
 MYRTLE BEACH, SOUTH CAROLINA

SCALE: 1"=150'	JOB NUMBER:
REVISED BY: AYS	IN-HOUSE DATE: 10/07/2005
CAD FILENAME: CGSITE	
DRAWING NUMBER:	

SP 1

THIS PLAN SHALL NOT BE DEEMED TO BE A WARRANTY, REPRESENTATION OR AGREEMENT ON THE PART OF THE LANDLORD THAT THE SHOPPING CENTER WILL BE, OR WILL CONTINUE TO BE AS INDICATED HEREON WITHOUT CHANGE. LANDLORD MAY, FROM TIME TO TIME, INCREASE, REDUCE, AND/OR CHANGE THE PARKING AREAS OR COMMON AREAS AS LANDLORD SHALL DEEM PROPER. LANDLORD RESERVES THE RIGHT TO CHANGE THE GENERAL LAYOUT, AND TO MAKE ALTERATIONS AND ADDITIONS TO, AND TO BUILD ADDITIONAL STORIES ON THE BUILDING IN WHICH THE PREMISES ARE CONTAINED OR WHICH OTHERWISE COMPRISE THE SHOPPING CENTER AND TO MAKE ANY OTHER CHANGES AS MAY BE REQUIRED BY APPLICABLE CODE OR AUTHORITIES. THIS PLAN IS SUBJECT TO CHANGE, AND IS NOT A WARRANTY, REPRESENTATION OR AGREEMENT THAT PROSPECTIVE TENANTS OR ANCHOR STORES SHOWN HEREON WILL BE TENANTS OR ANCHOR STORES AT THE LOCATIONS SHOWN OR AT ANY OTHER LOCATION IN THE SHOPPING CENTER.